

CABLE CHAIN SERIES

方形鏈條護管系列

CE RoHS



SQ303 封閉式鏈條護管 (護蓋可掀開 | 標準型)

SQ303 CABLE CHAIN (Protection cover can be opened | Standard type)

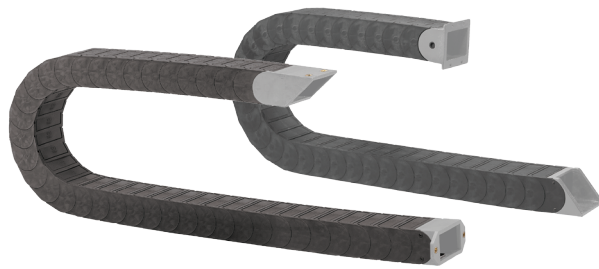

中華民國專利號碼：第222682號
R.O.C. Patent No. : 222682

TYPE-SQ303

材質：

護管係工程塑鋼射出成型，法蘭係塑鋼射出或鋁合金壓鑄成型。

特長：

- (一) 以「不夾鐵屑」之功能設計，容易擦拭清理。
- (二) 護管游動時平順美觀。
- (三) 剛性強韌不變形。
- (四) 護管之長度可任意增長或減短。
- (五) 保養內部管線時，可隨即掀開護蓋施工。

說明：

- a. 護蓋能開啟。
- b. 適中負載及中行程之游動。
- c. 適用於電腦機床、龍門搪銑床、綜合加工機、自動倉儲、停車塔及產業機械等。

Material:

The Cable chain is injected polyester. The flange is made of injected polyester or die-cast aluminum alloy.

Advantages:

- (1) Special design that doesn't trap metal chips for easy cleaning.
- (2) Quiet and smooth motion with elegant flex line.
- (3) Hing rigidity, no deformation.
- (4) Adjustable length.
- (5) Open protection lid for maintenance.

Direction:

- a. Protection cover can be opened.
- b. Moderate load and movement.
- c. Apply to computer machine tools, milling planner, machining center, automatic warehouse, parking tower, industrial machinery etc.

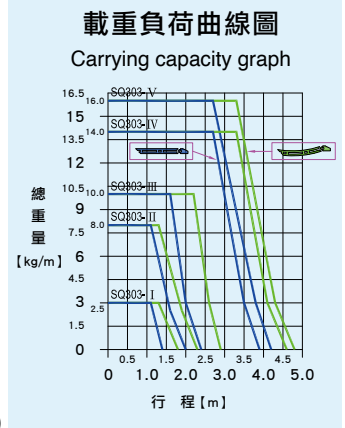
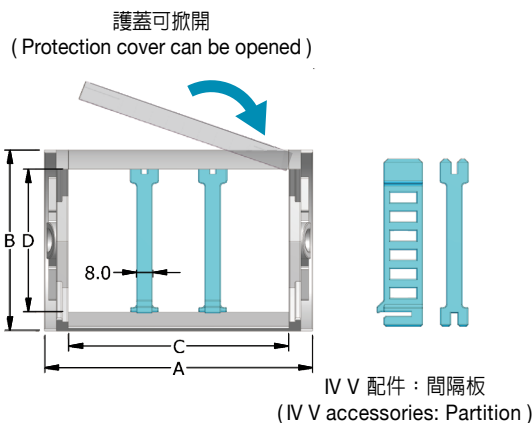
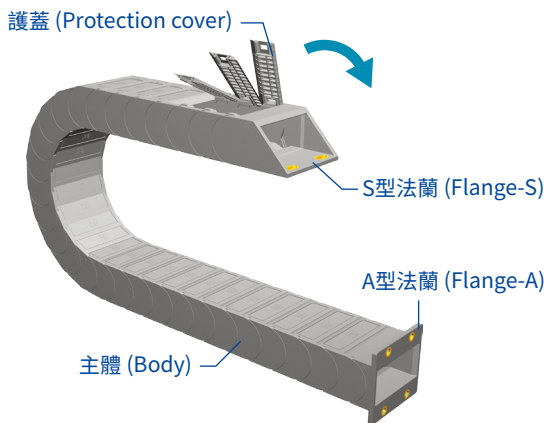

		尺寸表 (採一般公差)				Specification (Approx) mm					
番號		節距				彎曲半徑(實質高度 Hs)					重量
TYPE	A	B	C	D	Pitch	R (Hs)	R (Hs)	R (Hs)	R (Hs)	R (Hs)	kg/M
I	55	35	45	25	25.5	60 (180)	100 (260)	150 (360)	200 (460)		0.84
II	92	50	75	39	37.0	100 (275)	150 (375)	200 (475)	250 (575)		1.72
III	115	70	97	54	45.0	100 (295)	150 (395)	200 (495)	225 (545)	300 (695)	2.76
IV	135	95	111	75	60.0	150 (420)	200 (520)	300 (720)	450 (1020)		4.52
V	187	92	163	72	60.0	150 (417)	250 (617)	300 (717)	350 (817)	450 (1017)	5.52

SQ303 法蘭型式及裝置方法

SQ303 FLANGE TYPE & CABLE FLANGE ARRANGEMENTS

S型法蘭 FLANGE-S

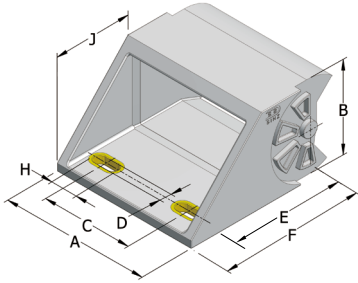

番號 TYPE	尺寸 Dimension (mm)										重量 Weight g/pc		材質 Material
	A	B	C	D	E _(m)	E _(f)	F _(m)	F _(f)	H	J	公端(m)	母端(f)	
I	55	35	23	7	41	41	51	51	14	25	37	32	塑鋼 Polyester
II	92	50	50	7	54	54	69	69	14	40	103	90	
III	115	70	71	9	83	83	103	103	20	60	265	243	鋁合金 Aluminum alloy
IV	137	96	70	9	84	96	97	109	29	86	604	654	
V	188	93	100	9	82	75	125	120	29	85	1026	933	

A型法蘭 FLANGE-A

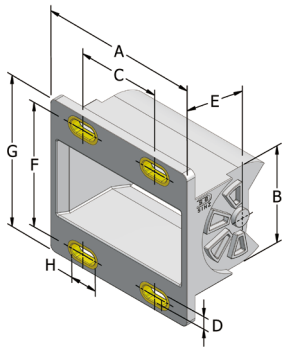

番號 TYPE	尺寸 Dimension (mm)										重量 Weight g/pc		材質 Material
	A	B	C	D	E _(m)	E _(f)	F	G	H	公端(m)	母端(f)		
I	55	35	22	7	26	26	55	71	14	41	36	塑鋼 Polyester	
II	92	50	45	7	35	35	70	88	14	99	86		
III	115	70	61	9	48	48	90	110	20	225	203	鋁合金 Aluminum alloy	
IV	136	96	60	9	54	41	110	130	29	570	519		
V	188	93	95	9	53	43	115	135	29	825	665		

B型法蘭 FLANGE-B

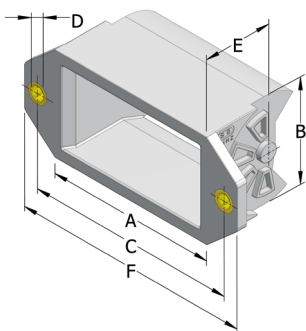

番號 TYPE	尺寸 Dimension (mm)							重量 Weight g/pc		材質 Material
	A	B	C	D	E _{(m)(f)}	F	公端(m)	母端(f)		
I	55	35	75	7	26	91	35	29	塑鋼 Polyester	
II	92	50	105	7	35	124	84	72		
III	115	70	141	9	48	161	202	171		

法蘭裝置方法 (Flange Arrangements)

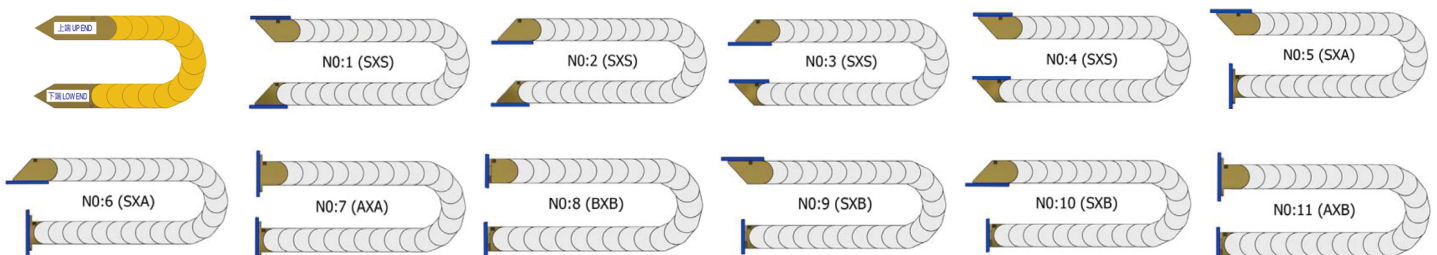

SQ303 結構功能、護蓋掀開及組合操作方法

SQ303 STRUCTURAL FUNCTION, SLEEVE LIFT & ASSEMBLY METHOD

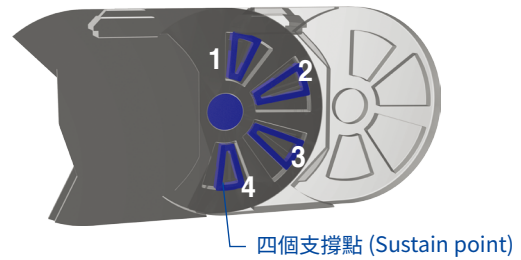
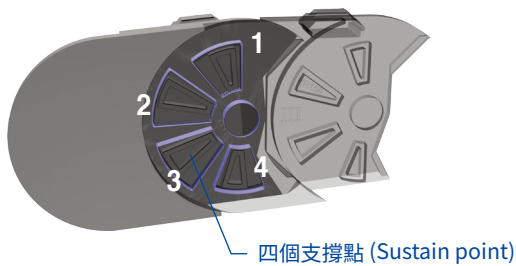

- 結構功能：設計四個受力支撐點，可增加抗拉及抗扭，相對可增加承載負荷。
Structure function : four weighted supporting point is designed to anti tensile and anti torque, and the carrying capacity is relatively bigger.

護蓋掀開及組合操作方法：Protection cover can be opened and installation arrangement.

- 拆解工具為5mm寬一字形起子 (Dismantling with 5mm slotted screwdriver)

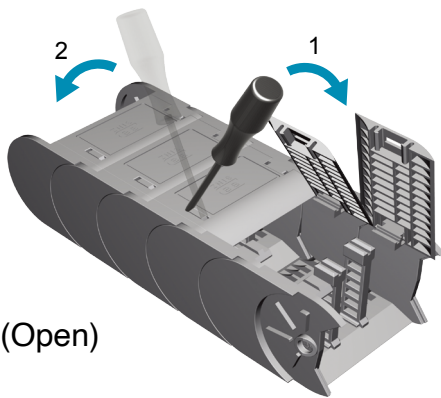

掀開 (Open)

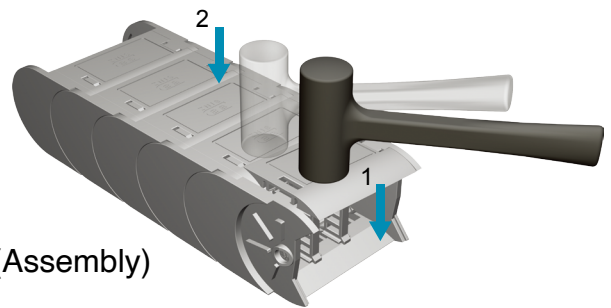

組合 (Assembly)

特殊用法：Special usage

當管路設計無法自法蘭端口出線時，則可沿管部內側加掛矩形塑框并用。
(加掛塑框之使用，只允可質輕管路，不適質重管路)。

While the designed conduits is not able to off track, then polyester rectangle frame will be used in the inner cable chain to resolve it. (Polyester rectangle frame can only be used with light conduits, not heavy conduits.)

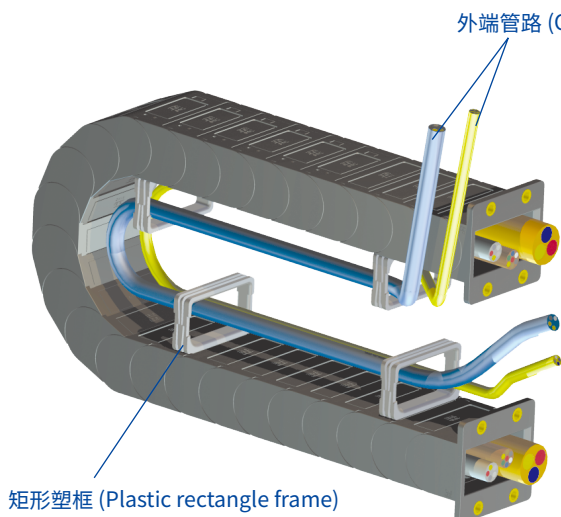

使用例 (Application example)

鏈條護管應用概念、長度計算方式

APPLICATION CONCEPT OF CABLE CHAIN, LENGTH CALCULATION

(一) 鏈條護管應用概念：實質高度

鏈條護管係以扣件組立而成，當其在進行游動時，扣件自然會往無平台支撐的一面稍微傾凸，致使護管實質高度(Hs)要比標準高度(H)略高，故在計算彎曲高度時，應以實質高度(Hs)為宜。

(1) APPLICATION CONCEPT OF CABLE CHAIN : REAL HEIGHT

The cable chain is made up of fasteners. And while moving moves, the fasteners will moves to the end which has no supporting point, and the real height (Hs) of protection pipe will be a little bit higher than the standard height (H). So, the bending height should be refers to the real height (Hs).

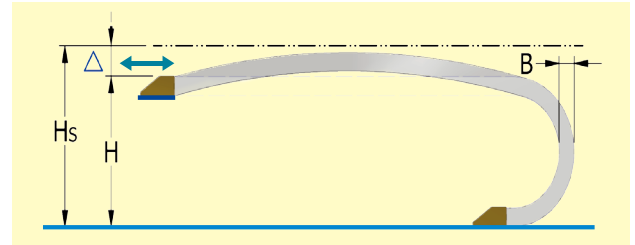

H	: 標準高度 (2R + B)	Standard height
Hs	: 實質高度 (2R + B + Δ)	Real height
B	: 護管厚度	Depth of cable chain
Δ	: 護管傾凸高度	Protection pipe protruding height

(二) 鏈條護管應用概念：管徑(規格)選項

鏈條護管管徑之選用，需以內容管線外徑之總和+20%為宜，其許可限制容積率在75~80%範圍，溢出此規範者屬不正確安裝。

(2) APPLICATION CONCEPT CABLE CHAIN : DIAMETER (SPECIFICATION) OPTION

The diameter of cable chain is based on 20%, and 75%~80% occupation coefficient is perfect, more than this percentage will be not allow.

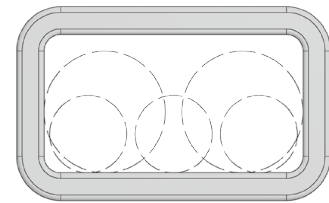

(三) 鏈條護管應用概念：允許下垂

平直狀態 (Straight ): 護管遊走時呈平直狀態。
 允許下垂狀態 (Permitted sag ): 護管遊走時呈允許下垂極限狀態。
 行程: 平直狀態和允許下垂狀態之行程長度請參考載重負荷曲線圖。

(3) APPLICATION CONCEPT CABLE CHAIN : PERMITTED SAG

Straight: Display the straight when a cable chain moves.
 Permitted Sag: Display the permitted sag when a cable chain moves.
 Stroke: For the stroke length of straight and permitted sag, please refer to load curve.

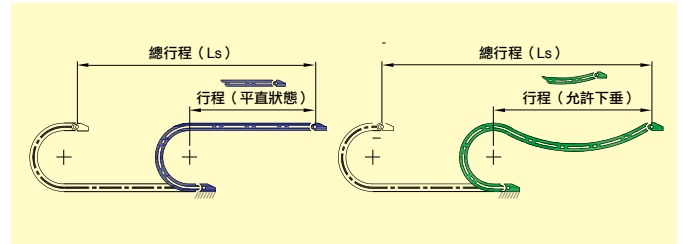

方形鏈條護管長度計算方式 (The cable chain length calculation method):

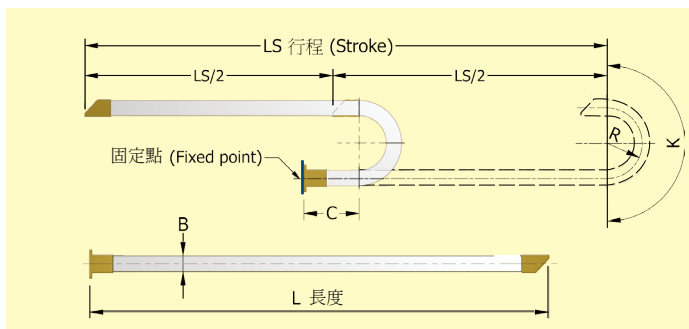

$$L(\text{長度}) = LS/2 + K + C$$

- R : 彎曲半徑 Bending Radius
- C : 呆滯長度 Remained Length
- K : 圓周長度 : πR ($\pi= 3.5$)
Circumference Length: πR ($\pi= 3.5$)

SQ603 輕巧型開放式鏈條護管 (橫桿不可掀開)

SQ603 CABLE CHAIN (Cross shaft cannot be opened)

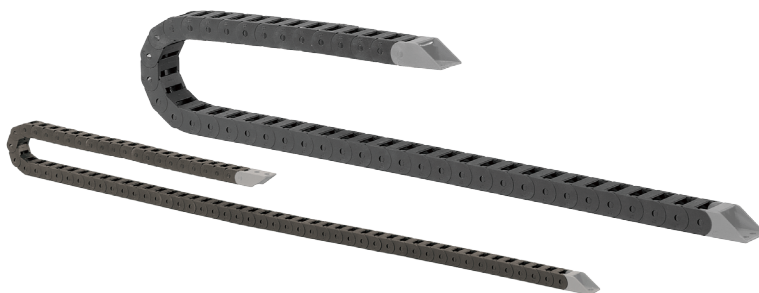

TYPE-SQ603

材質：

護管與法蘭係工程塑鋼射出成型。

特長：

- (一) 護管游動時平順美觀。
- (二) 耐蝕性佳，不變形。
- (三) 護管之長度可任意增長或減短。

說明：

- a. 輕質框形設計，橫桿不能開啟。
- b. 適低負載及短行程之游動。
- c. 適用於機械手臂、電腦機床、線性滑軌、自動倉儲、停車塔、洗車機及產業機械等。

Material:

The Cable chain and flange are injected polyester.

Advantages:

- (1) Quiet and smooth motion with elegant flex line.
- (2) Good corrosion resistance, deformation free.
- (3) Adjustable length.

Direction:

- a. Light frame shaped design, the cross shaft can't be opened.
- b. Apply to low carry capacity and short travel route movement.
- c. Apply to industrial robot arm, computer controlled machine tool, linear guideway, automatic warehouse, parking tower, and carriage cleaner, and industrial machinery.

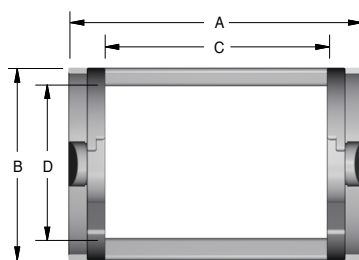
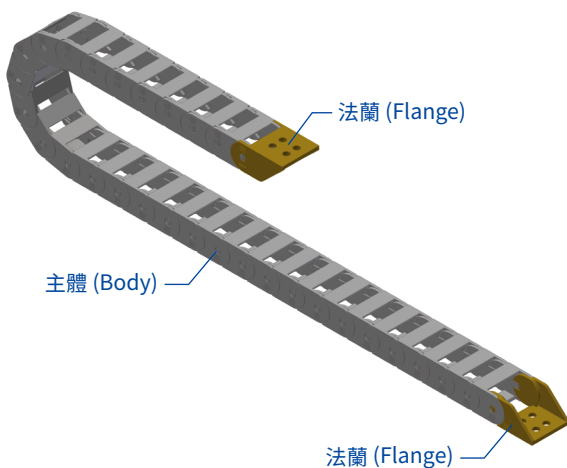

載重負荷曲線圖
Carrying capacity graph

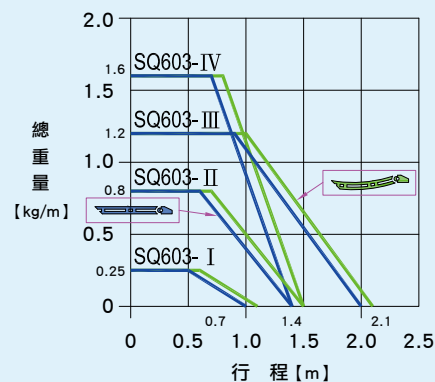

尺寸表 (採一般公差) Specification (Approx) mm

番號	節距				彎曲半徑(實質高度 Hs)			重量 kg/M	
	A	B	C	D	Pitch	R (Hs)	R (Hs)		R (Hs)
TYPE	A	B	C	D	Pitch	R (Hs)	R (Hs)	R (Hs)	Weight
I	16	13	10	10	14.0	18 (59)	28 (79)	38 (99)	0.13
II	23	19	15	15	20.0	20 (69)	35 (99)	50 (129)	0.25
III	34	24	25	19	24.0	38 (110)	48 (130)	75 (184)	0.35
IV	40	26	30	20	27.0	25 (86)	50 (136)		0.44

SQ603 法蘭型式及裝置方法

SQ603 FLANGE TYPE & CABLE FLANGE ARRANGEMENTS

S型法蘭 FLANGE-S

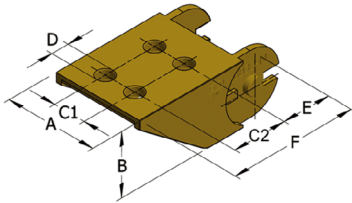

塑鋼法蘭

番號 TYPE	尺寸 Dimension (mm)							重量 Weight g/pc
	A	B	C1	C2	D	E	F	
I	16	13	—	12	5	11.0	29	2.2
II	23	19	—	15	6.4	15.0	38	5.6
III	34	24	12	20	6	18.0	47	10.8
IV	40	26	11	15	6.4	18.0	43	11.8

法蘭裝置方法 (Flange Arrangements)

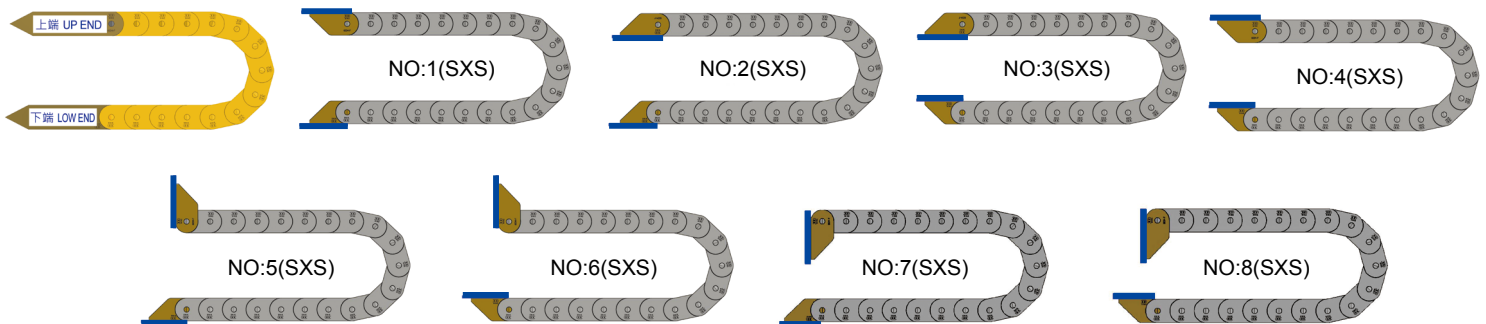

鏈條護管應用概念及長度計算方式，請參閱第011頁

Refer to page 011 for application concept of cable chain, length calculation.

購買鏈條護管時稱呼，請參閱第092頁

When buying cable chains, please refer to page 092.

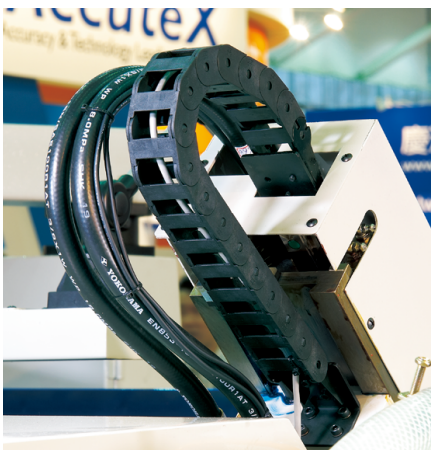

使用例 (Application example)

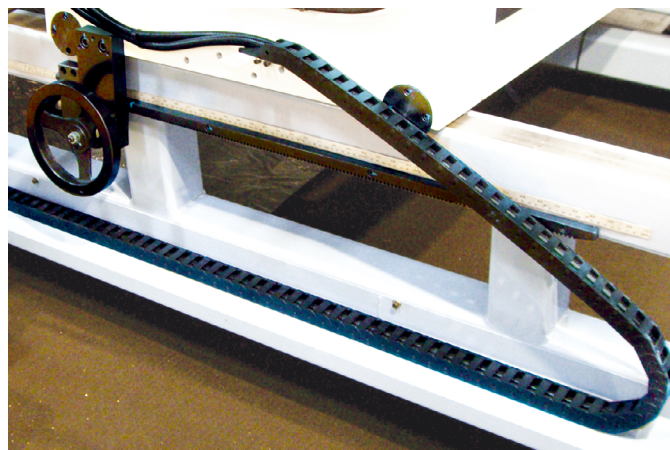

使用例 (Application example)

SQ604 輕型開放式鏈條護管 (橫桿可掀開)

SQ604 CABLE CHAIN (Cross shaft can be opened)



中華民國專利號碼：第M254803號
R.O.C. Patent Pending No. : M254803

TYPE-SQ604

材質：

護管與法蘭係工程塑鋼射出成型。

特長：

- (一) 耐蝕性佳，不變形。
- (二) 護管之長度可任意增長或減短。
- (三) 保養內部管線時，可隨即打開橫桿作業。

說明：

- a. 輕質設計，橫桿能開啟。
- b. 適低負載及短行程之游動。
- c. 適用於機械手臂、電腦機床、線性滑軌、自動倉儲、停車塔、洗車機及產業機械等。

Material:

The Cable chain and flange are injected polyester.

Advantages:

- (1) Good corrosion resistance, deformation free.
- (2) Adjustable length.
- (3) Open protection lid for interior cable maintenance.

Direction:

- a. Light frame shaped design, the rail is not able to turn on.
- b. Apply to low carry capacity and short travel route movement.
- c. Apply to industrial robot arm, computer controlled machine tool, linear guideway sleek orbit, automatic warehouse, parking tower, and carriage cleaner, and industrial machinery.

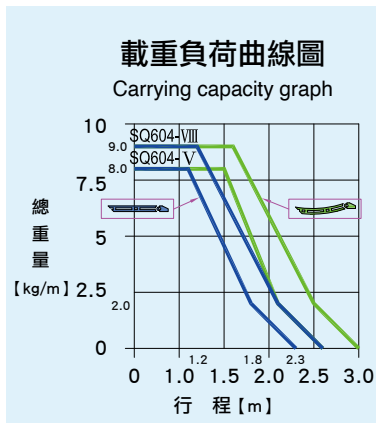
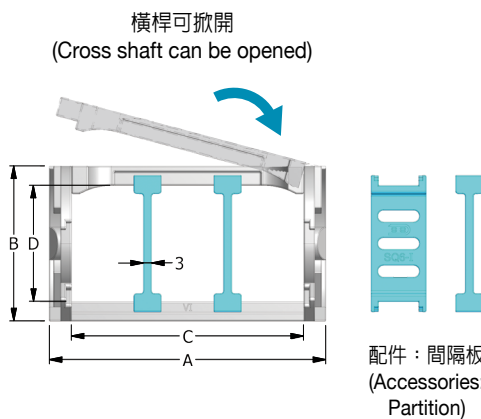
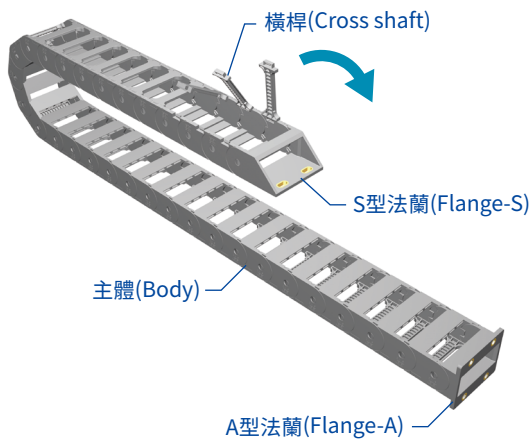

尺寸表 (採一般公差) Specification (Approx) mm										
番號	節距				彎曲半徑 (實質高度 Hs)				重量	
	TYPE	A	B	C	D	Pitch	R (Hs)	R (Hs)		R (Hs)
III	58	44	41	32	47.5	40 (149)	100 (269)	150 (369)	200 (469)	1.05
IV	78	44	61	32	47.5	40 (149)	100 (269)	150 (369)	200 (469)	1.15
V	100	44	83	32	47.5	40 (149)	100 (269)	150 (369)	200 (469)	1.47
VI	102	56	85	42	62.5	100 (281)	150 (381)	200 (481)	250 (581)	1.60
VII	122	56	105	42	62.5	100 (281)	150 (381)	200 (481)	250 (581)	1.76
VIII	142	56	125	42	62.5	100 (281)	150 (381)	200 (481)	250 (581)	1.92

SQ604 法蘭型式和裝置方法

SQ604 FLANGE TYPE & CABLE FLANGE ARRANGEMENTS

S型法蘭 FLANGE-S

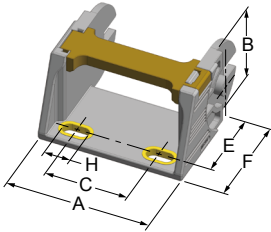

III、IV、V：法蘭橫桿可掀開。
VI、VII、VIII：法蘭沒有橫桿。

番號 TYPE	尺寸 Dimension (mm)							重量 Weight g/pc
	A	B	C	D	E	F	H	
III	58	44	25.0	7	41.5	51	14	52.0
IV	78	44	45.0	7	41.5	51	14	59.0
V	100	44	65.0	7	41.5	51	14	67.0
VI	101	56	43.0	9	78.5	91	20	173.0
VII	121	56	62.0	9	78.5	91	20	197.0
VIII	141	56	83.0	9	78.5	91	20	217.0

A型法蘭 FLANGE-A

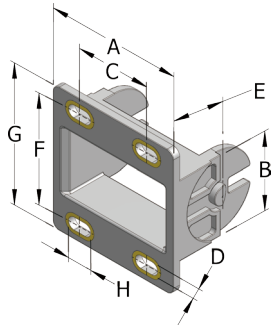

番號 TYPE	尺寸 Dimension (mm)								重量 Weight g/pc
	A	B	C	D	E	F	G	H	
III	58	44	22	7	31	61	78	14	56.0
IV	78	44	42	7	31	61	78	14	57.0
V	100	44	64	7	31	61	78	14	66.0
VI	101	56	43	9	43	75	94	20	154.0
VII	121	56	62	9	43	75	94	20	175.0
VIII	141	56	83	9	43	75	94	20	200.0

B型法蘭 FLANGE-B

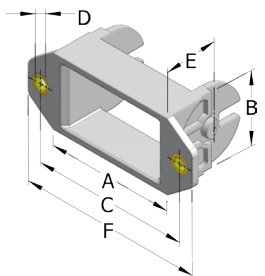

番號 TYPE	尺寸 Dimension (mm)						重量 Weight g/pc
	A	B	C	D	E	F	
III	58	44	73	7	31	90	48.0
IV	78	44	93	7	31	110	52.0
V	100	44	115	7	31	132	57.0
VI	101	56	121	9	43	139	130.0
VII	121	56	140	9	43	158	144.0
VIII	141	56	161	9	43	179	157.0

法蘭裝置方法 (Flange Arrangements)

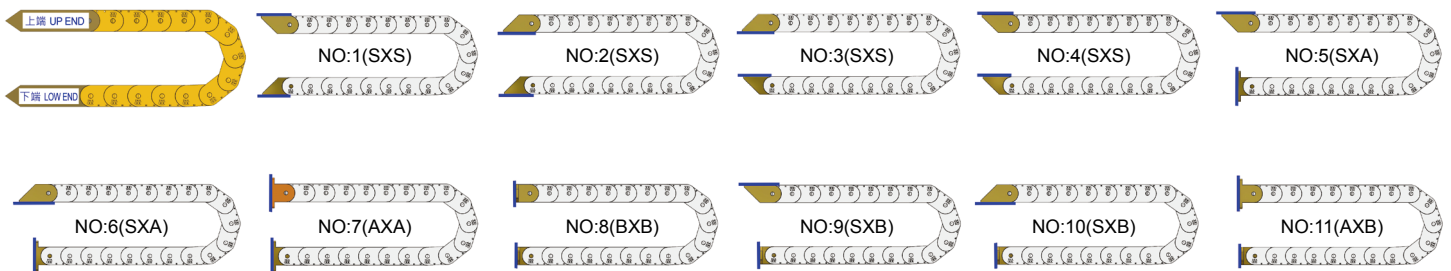

鏈條護管應用概念、長度計算方式，請參閱第011頁
Refer to page 011 for application concept of cable chain, length calculation.

購買鏈條護管時稱呼，請參閱第092頁
When buying cable chains, please refer to page 092.

SQ812 輕型開放式鏈條護管 (橫桿可掀開、拆卸)

SQ812 CABLE CHAIN (Cross shaft can be opened)

發明專利號碼：I609140

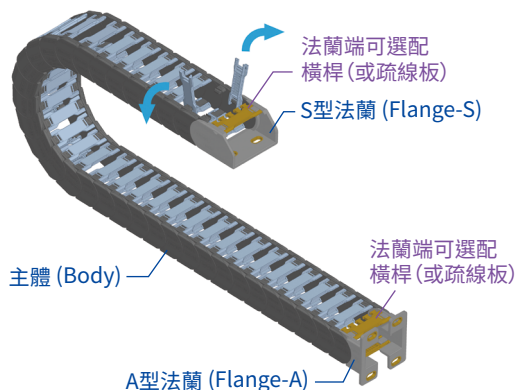

TYPE-SQ812

橫桿可向左或右掀開
(Cross shaft can be opened)

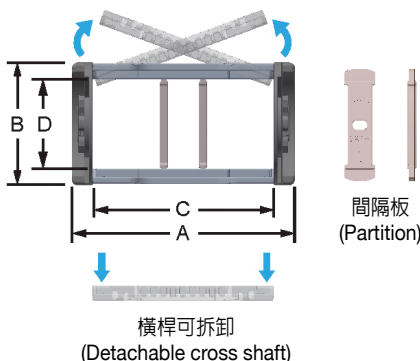

載重負荷曲線圖

Carrying capacity graph

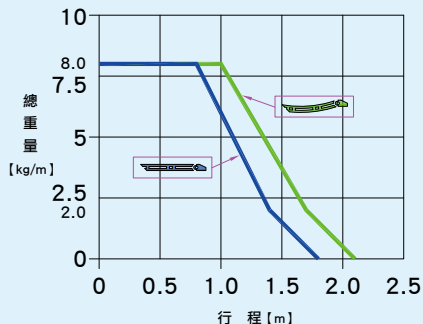

材質：

護管與法蘭係工程塑鋼射出成型。

特長：

- (一) 耐蝕性佳，不變形。
- (二) 護管之長度可任意增長或減短。
- (三) 保養內部管線時，可隨即打開橫桿作業。

說明：

- a. 輕質設計，橫桿能開啟。
- b. 適低負載及短行程之游動。
- c. 適用於機械手臂、電腦機床、線性滑軌、自動倉儲、停車塔、洗車機及產業機械等。

Material:

The Cable chain and flange are injected polyester.

Advantages:

- (1) Good corrosion resistance, deformation free.
- (2) Adjustable length.
- (3) Open protection lid for interior cable maintenance.

Direction:

- a. Light frame shaped design, rail is able to turn on.
- b. Apply to low carry capacity and short travel route movement.
- c. Apply to industrial robot arm, computer controlled machine tool, linear guideway sleek orbit, automatic warehouse, parking tower, and carriage cleaner, and industrial machinery.

尺寸表 (採一般公差) Specification (Approx) mm

番號 TYPE	節距				彎曲半徑(實質高度 Hs) Bending Radius (Real Height Hs)					重量 Weight kg/M	
	A	B	C	D	Pitch	R (Hs)	R (Hs)	R (Hs)	R (Hs)		R (Hs)
I	60	44	45	32	30	35 (134)	70 (204)	100 (264)	150 (364)	200 (464)	1.18
II	80	44	65	32	30	35 (134)	70 (204)	100 (264)	150 (364)	200 (464)	1.27
III	100	44	85	32	30	35 (134)	70 (204)	100 (264)	150 (364)	200 (464)	1.35
IV	120	44	105	32	30	35 (134)	70 (204)	100 (264)	150 (364)	200 (464)	1.48

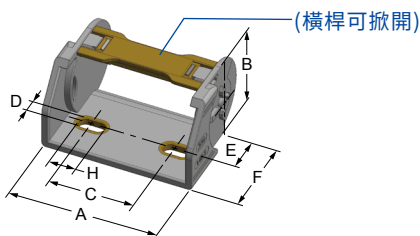

S型法蘭 FLANGE-S

番號 TYPE	尺寸 Dimension(mm)										重量 Weight g/pc		
	A	B	C	D	E(m)	E(f)	F(m)	F(f)	H	(m)	(f)	(m)	(f)
I	60	44	25	7	22	35	42	55	14	40.6	54.0		
II	80	44	45	7	22	35	42	55	14	47.0	61.2		
III	100	44	65	7	22	35	42	55	14	53.6	68.6		
IV	120	44	85	7	22	35	42	55	14	58.0	72.4		

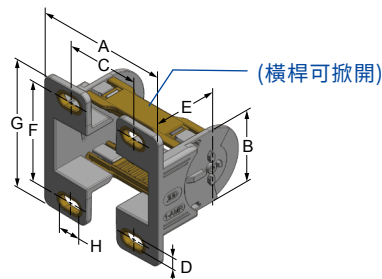

A型法蘭 FLANGE-A

番號 TYPE	尺寸 Dimension(mm)										重量 Weight g/pc		
	A	B	C	D	E(m)	E(f)	F	G	H	(m)	(f)	(m)	(f)
I	60	44	25	7	41	60	62	78	14	58.6	80.5		
II	80	44	44	7	41	60	62	78	14	62.8	84.7		
III	100	44	65	7	41	60	62	78	14	66.4	88.3		
IV	120	44	85	7	41	60	62	78	14	70.4	92.3		

SQ813 輕型封閉式鏈條護管 (護蓋可掀開、拆卸)

SQ813 CABLE CHAIN (Protection cover can be opened) 發明專利號碼：I609140

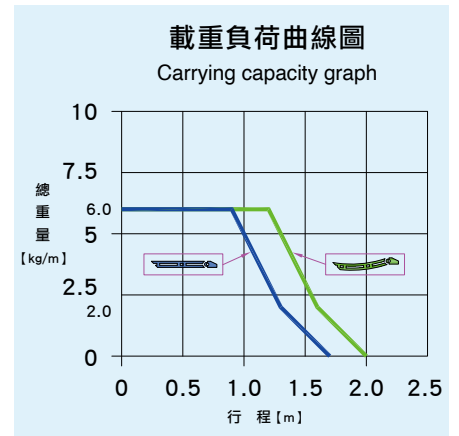
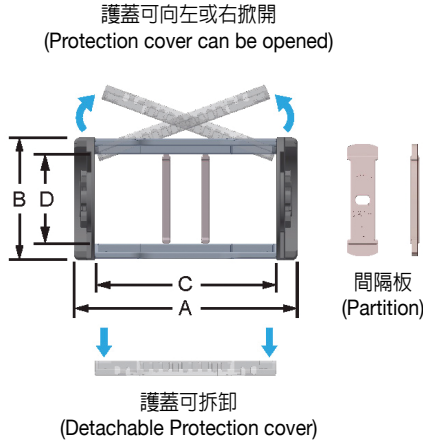
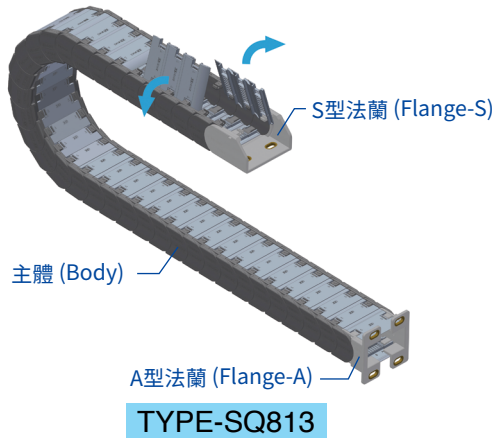

材質：

護管與法蘭係工程塑鋼射出成型。

特長：

- (一) 耐蝕性佳，不變形。
- (二) 護管之長度可任意增長或減短。
- (三) 保養內部管線時，可隨即打開護蓋作業。
- (四) 以「不夾鐵屑」之功能設計，容易擦拭清理。

說明：

- a. 輕質設計，護蓋能開啟。
- b. 適低負載及短行程之游動。
- c. 適用於機械手臂、電腦機床、線性滑軌、自動倉儲、停車塔、洗車機及產業機械等。

Material:

The Cable chain and flange are injected polyester.

Advantages:

- (1) Good corrosion resistance, deformation free.
- (2) Adjustable length.
- (3) Open protection lid for maintenance.
- (4) Special design that doesn't trap metal chips for easy cleaning.

Direction:

- a. Light frame shaped design, Protection cover is unsealed.
- b. Apply to low carry capacity and short travel route movement.
- c. Apply to industrial robot arm, computer controlled machine tool, linear guideway sleek orbit, automatic warehouse, parking tower, and carriage cleaner, and industrial machinery.

尺寸表 (採一般公差) Specification (Approx) mm

番號 TYPE	節距				彎曲半徑(實質高度 Hs) Bending Radius (Real Height Hs)				重量 Weight kg/M	
	A	B	C	D	Pitch	R (Hs)	R (Hs)	R (Hs)		R (Hs)
I	60	44	45	32	30	70 (204)	100 (264)	150 (364)	200 (464)	1.25
II	80	44	65	32	30	70 (204)	100 (264)	150 (364)	200 (464)	1.39
III	100	44	85	32	30	70 (204)	100 (264)	150 (364)	200 (464)	1.53
IV	120	44	105	32	30	70 (204)	100 (264)	150 (364)	200 (464)	1.67

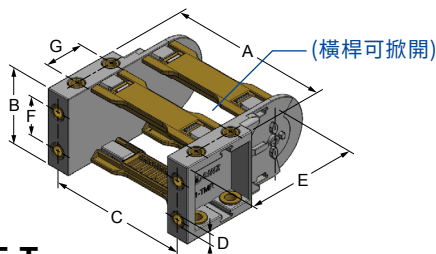

T型法蘭 FLANGE-T

番號 TYPE	尺寸 Dimension(mm)								重量 Weight g/pc	
	A	B	C	D	E(m)	E(f)	F	G	(m)	(f)
I	72	44	59.5	5.7	66.4	85.5	22	22.5	79.8	104.2
II	92	44	79.5	5.7	66.4	85.5	22	22.5	90.2	115.4
III	112	44	99.5	5.7	66.4	85.5	22	22.5	100.2	125.8
IV	132	44	119.5	5.7	66.4	85.5	22	22.5	109.4	136.2

法蘭裝置方法 (Flange Arrangements)

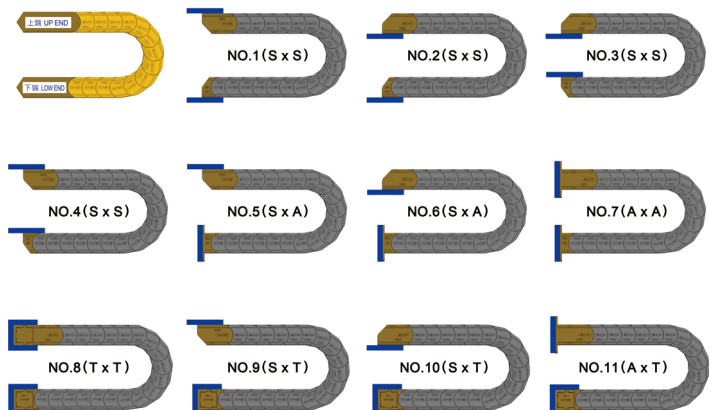

SQ822 輕型開放式鏈條護管 (橫桿可掀開、拆卸)

SQ822 CABLE CHAIN (Cross shaft can be opened)

發明專利號碼：I702764

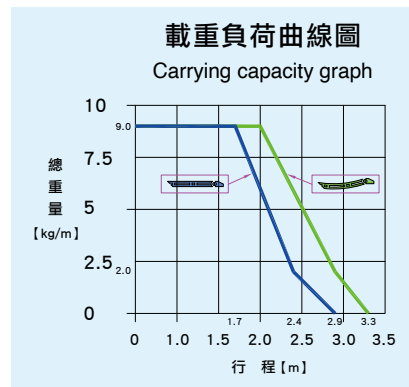
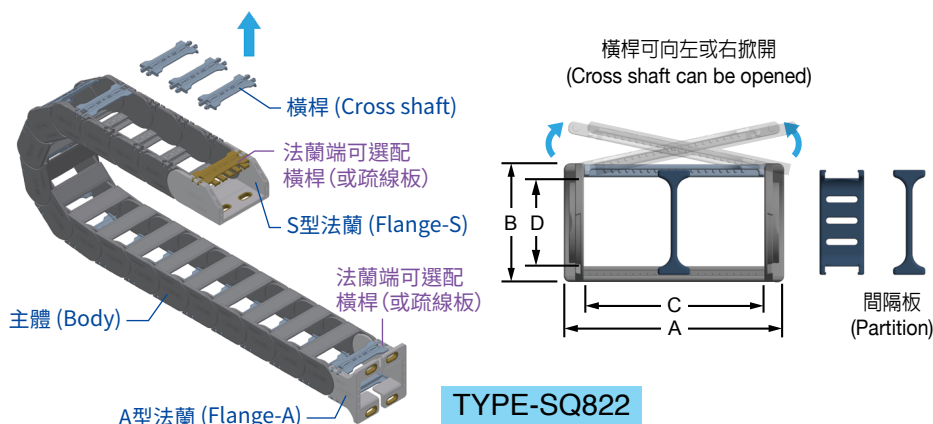

TYPE-SQ822

材質：

護管與法蘭係工程塑鋼射出成型。

特長：

- (一) 耐蝕性佳，不變形。
- (二) 護管之長度可任意增長或減短。
- (三) 保養內部管線時，可隨即打開橫桿作業。

說明：

- a. 輕質設計，橫桿能開啟。
- b. 適低負載及短行程之游動。
- c. 適用於機械手臂、電腦機床、線性滑軌、自動倉儲、停車塔、洗車機及產業機械等。

Material:

The Cable chain and flange are injected polyester.

Advantages:

- (1) Good corrosion resistance, deformation free.
- (2) Adjustable length.
- (3) Open protection lid for interior cable maintenance.

Direction:

- a. Light frame shaped design, Protection cover is unsealed.
- b. Apply to low carry capacity and short travel route movement.
- c. Apply to industrial robot arm, computer controlled machine tool, linear guideway sleek orbit, automatic warehouse, parking tower, and carriage cleaner, and industrial machinery.

番號	尺寸表 (採一般公差)						Specification (Approx) mm					重量 kg/M
	A	B	C	D	Pitch	R (Hs)	彎曲半徑(實質高度 Hs) Bending Radius (Real Height Hs)					
TYPE	A	B	C	D	Pitch	R (Hs)	R (Hs)	R (Hs)	R (Hs)	R (Hs)	R (Hs)	
I	104	56	85	42	60	70 (221)	100 (281)	150 (381)	200 (481)	250 (581)	1.82	
II	124	56	105	42	60	70 (221)	100 (281)	150 (381)	200 (481)	250 (581)	1.95	
III	144	56	125	42	60	70 (221)	100 (281)	150 (381)	200 (481)	250 (581)	2.09	
IV	169	56	150	42	60	70 (221)	100 (281)	150 (381)	200 (481)	250 (581)	2.27	

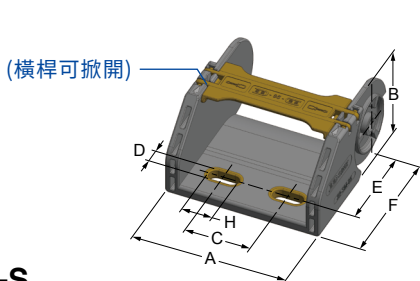

S型法蘭 FLANGE-S

番號	尺寸 Dimension(mm)							重量 Weight g/pc	
	A	B	C	D	E	F	H	(m)	(f)
I	104	56	43	8.5	60	80	20	152.8	157.1
II	124	56	62	8.5	60	80	20	170.5	175.5
III	144	56	83	8.5	60	80	20	189.1	194.6
IV	169	56	108	8.5	60	80	20	214.2	220.5

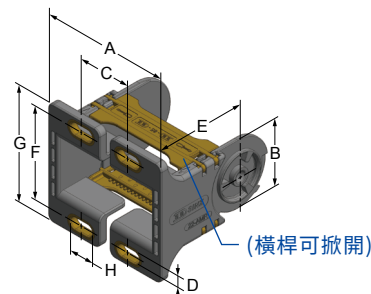

A型法蘭 FLANGE-A

番號	尺寸 Dimension(mm)								重量 Weight g/pc	
	A	B	C	D	E	F	G	H	(m)	(f)
I	104	56	43	9	75.5	75	94	20	167.4	166.7
II	124	56	63	9	75.5	75	94	20	173.4	172.7
III	144	56	83	9	75.5	75	94	20	180.5	179.8
IV	169	56	108	9	75.5	75	94	20	191.5	190.8

SQ823 輕型封閉式鏈條護管 (護蓋可掀開、拆卸)

SQ823 CABLE CHAIN (Protection cover can be opened)

發明專利號碼：I702764

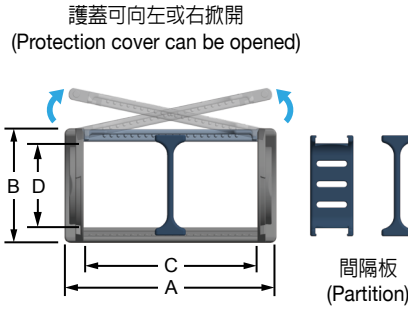
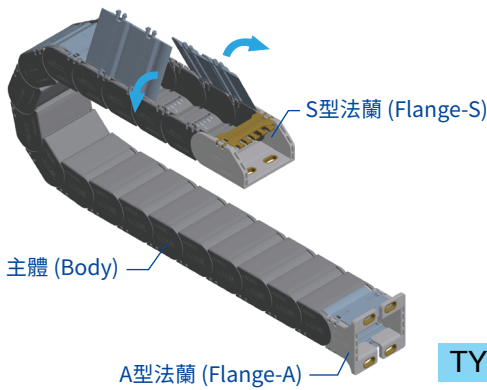

TYPE-SQ823

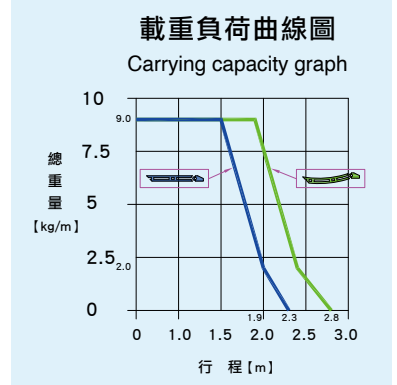

材質：

護管與法蘭係工程塑鋼射出成型。

特長：

- (一) 耐蝕性佳，不變形。
- (二) 護管之長度可任意增長或減短。
- (三) 保養內部管線時，可隨即打開護蓋作業。
- (四) 以「不夾鐵屑」之功能設計，容易擦拭清理。

說明：

- a. 輕質設計，護蓋能開啟。
- b. 適低負載及短行程之游動。
- c. 適用於機械手臂、電腦機床、線性滑軌、自動倉儲、停車塔、洗車機及產業機械等。

Material:

The Cable chain and flange are injected polyester.

Advantages:

- (1) Good corrosion resistance, deformation free.
- (2) Adjustable length.
- (3) Open protection lid for maintenance.
- (4) Special design that doesn't trap metal chips for easy cleaning.

Direction:

- a. Light frame shaped design, Protection cover is unsealed.
- b. Apply to low carry capacity and short travel route movement.
- c. Apply to industrial robot arm, computer controlled machine tool, linear guideway sleek orbit, automatic warehouse, parking tower, and carriage cleaner, and industrial machinery.

番號	尺寸表 (採一般公差)				Specification (Approx) mm				重量 Weight kg/M	
	A	B	C	D	Pitch	彎曲半徑(實質高度 Hs) Bending Radius (Real Height Hs)				
I	104	56	85	42	60	100 (281)	150 (381)	200 (481)	250 (581)	2.31
II	124	56	105	42	60	100 (281)	150 (381)	200 (481)	250 (581)	2.55
III	144	56	125	42	60	100 (281)	150 (381)	200 (481)	250 (581)	2.80
IV	169	56	150	42	60	100 (281)	150 (381)	200 (481)	250 (581)	3.11

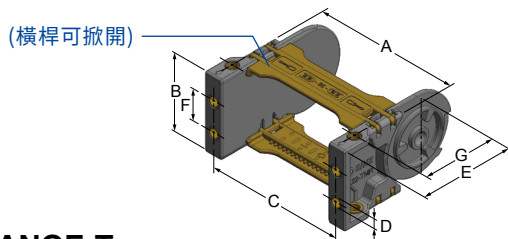

T型法蘭 FLANGE-T

番號	尺寸 Dimension(mm)							重量 Weight g/pc (f)	
	A	B	C	D	E	F	G	(m)	(f)
I	112	56	98.5	6.5	67.5	22	52.5	112.7	113.2
II	132	56	118	6.5	67.5	22	52.5	122.2	122.7
III	152	56	138	6.5	67.5	22	52.5	133.2	133.7
IV	177	56	163.5	6.5	67.5	22	52.5	150.8	151.3

法蘭裝置方法 (Flange Arrangements)

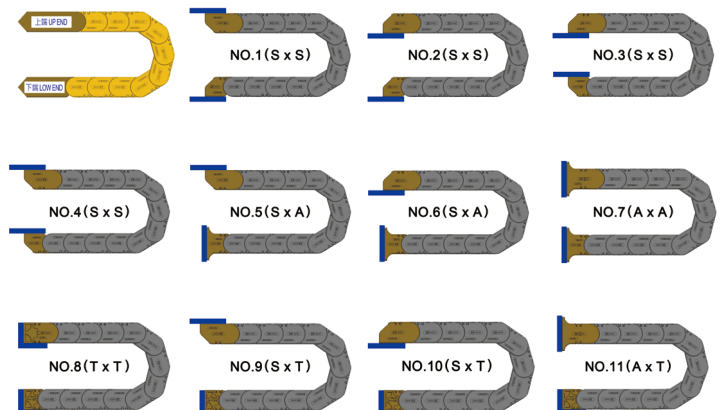

SQ812、SQ813、SQ822、SQ823 系列間隔板及橫隔板配置

SQ812、SQ813、SQ822、SQ823 SERIES PARTITION AND HORIZON SEPARATOR

SQ812、SQ813

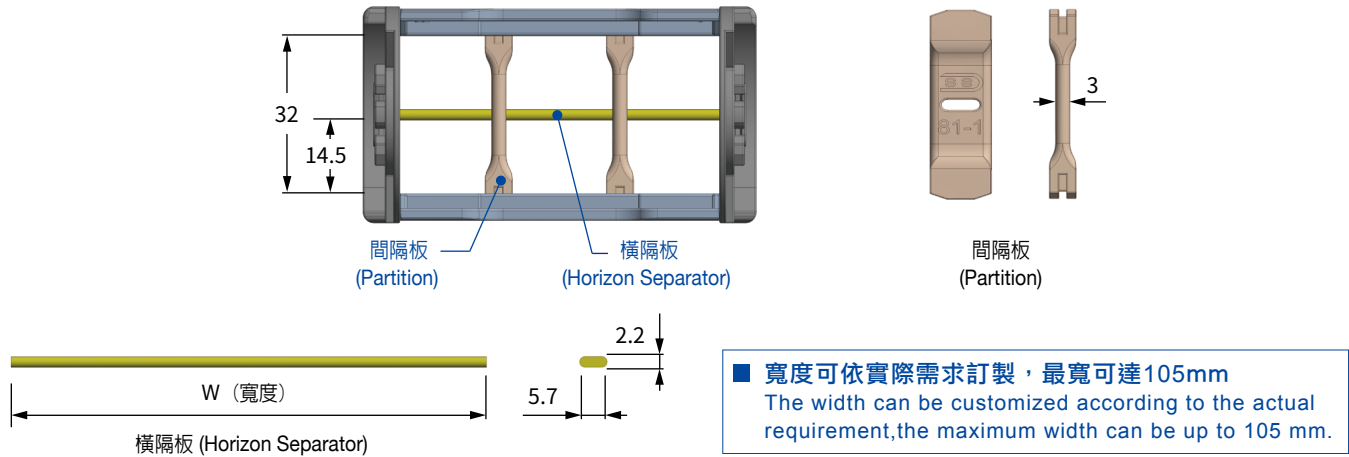

SQ822、SQ823

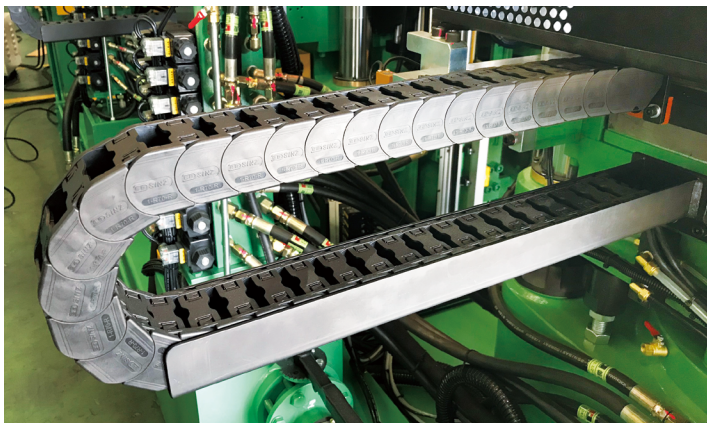
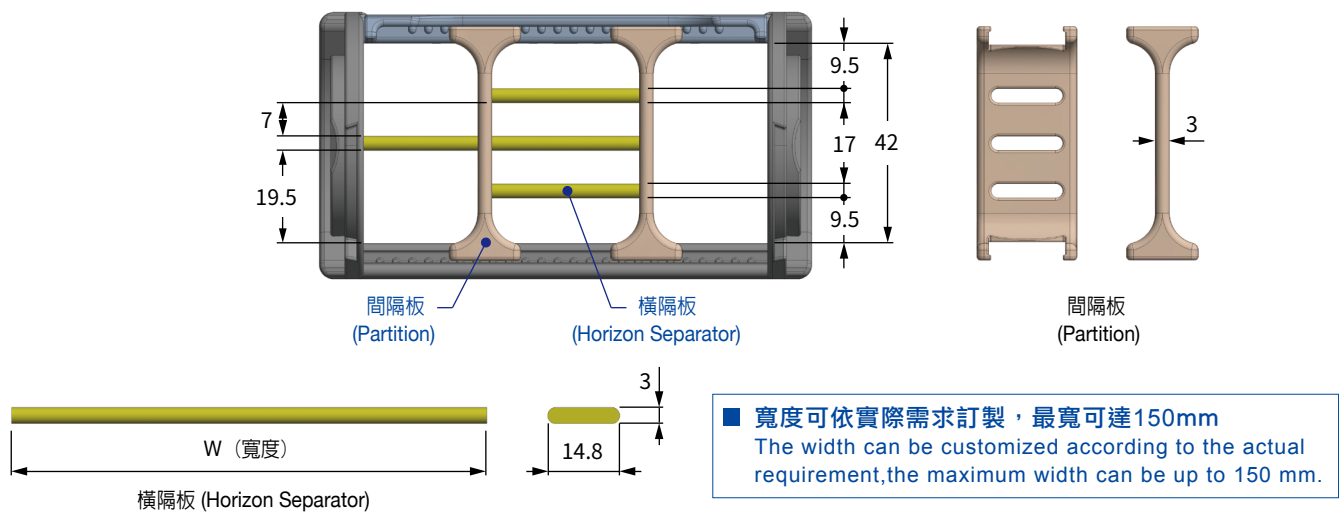

SQ812 開放型使用例 (Application example)



SQ823 封閉型使用例 (Application example)

SQ602 輕巧型封閉式鏈條護管 (護蓋不可掀開)

SQ602 CABLE CHAIN (Protection cover cannot be opened)



中華民國專利號碼：第M436270號
R.O.C.Patent No. : M436270

TYPE-SQ602

材質：

護管與法蘭係工程塑鋼射出成型。

特長：

- (一) 耐蝕性佳，不變形。
- (二) 護管之長度可任意增長或減短。

說明：

- a. 輕質框形設計，護蓋不能開啟。
- b. 適低負載及短行程之游動。
- c. 適用於機械手臂、電腦機床、線性滑軌、自動倉儲、停車塔、洗車機及產業機械等。

Material:

The Cable chain and flange are injected polyester.

Advantages:

- (1) Good corrosion resistance, deformation free.
- (2) Adjustable length.

Direction:

- a. Light frame shaped design, the cross shaft can't be opened.
- b. Apply to low carry capacity and short travel route movement.
- c. Apply to industrial robot arm, computer controlled machine tool, linear guideway, automatic warehouse, parking tower, and carriage cleaner, and industrial machinery.

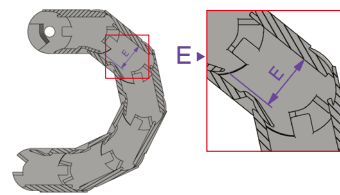
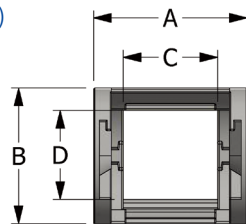
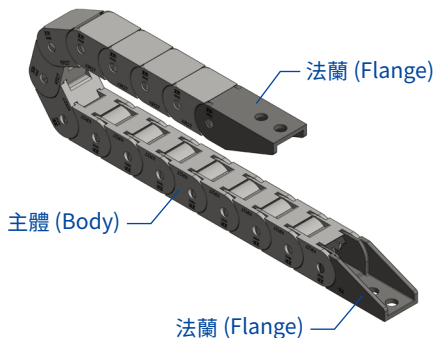

彎曲時，D尺寸會縮小至E尺寸。

載重負荷曲線圖

Carrying capacity graph

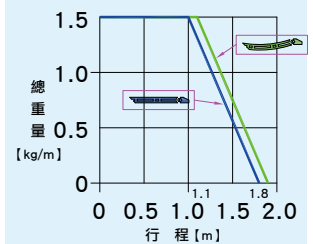

尺寸表 (採一般公差) Specification (Approx) mm

番號	尺寸				節距	彎曲半徑(實質高度 Hs) Bending Radius(Real Height Hs)		重量
TYPE	A	B	C	D	Pitch	R (Hs)	R (Hs)	Weight kg/M
I	26.0	23.0	16.0	15.1	25.0	27 (100) ; E=12.5	37 (120) ; E=14.5	0.4

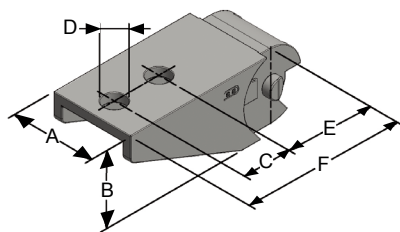

S型法蘭 FLANGE-S

番號	尺寸 Dimension (mm)						重量
TYPE	A	B	C	D	E	F	Weight g/pc
I	26.0	23.0	15.0	7.0	27.5	50.0	9.8

法蘭裝置方法 (Flange Arrangements)

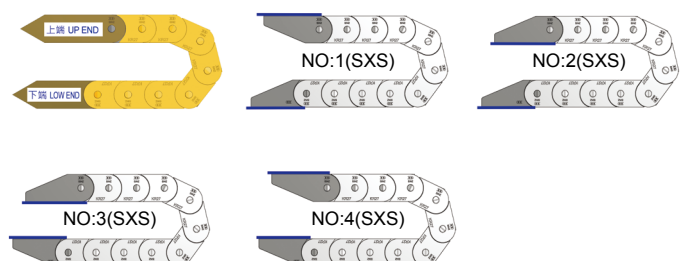

SQ402 重型開放式鏈條護管 (橫桿可拆卸)

SQ402 BAND CABLE CHAIN (Detachable cross shaft)

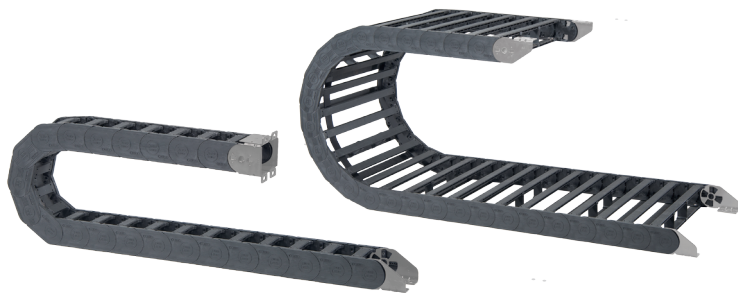

中華民國專利號碼：第I464334號
R.O.C.Patent No. : I464334

TYPE-SQ402

材質：

護管係工程塑鋼射出成型，法蘭係鋼板沖壓成型。

特長：

- (一) 耐蝕性佳，不變形。
- (二) 可承載重壓。
- (三) 護管之長度可任意增長或減短。
- (四) 保養內部管線時，可隨即打開橫桿作業。

說明：

- a. 承受重壓不變形，橫桿能開啟。
- b. 適重負載及中長行程之游動。
- c. 適用於電腦機床、龍門搪銑床、綜合加工機、機場空橋、水庫閘門、自動倉儲及產業機械等。

Material:

The Cable chain is injected polyester. The flange is stamped steel sheet.

Advantages:

- (1) Good corrosion resistance, deformation free.
- (2) Heavy duty.
- (3) Adjustable length.
- (4) Open protection lid for interior cable maintenance.

Direction:

- a. Not easy to twist under pressure, rail is able to turn on.
- b. Apply to heavy carrying capacity and middle-long movement.
- c. Apply to computer controlled machine tool, milling planner, machining center, airspace flyover, reservoir strobe, automatic warehouse, and industrial machinery.

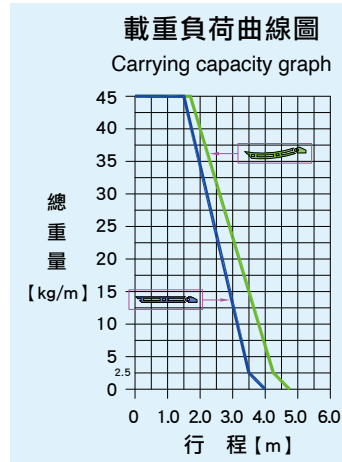
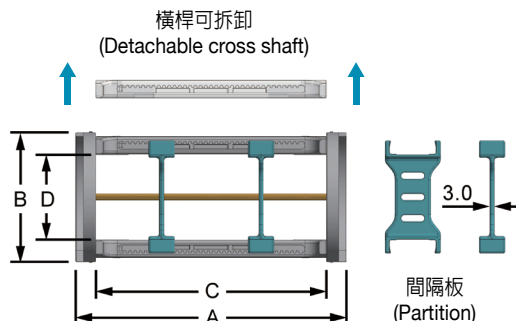
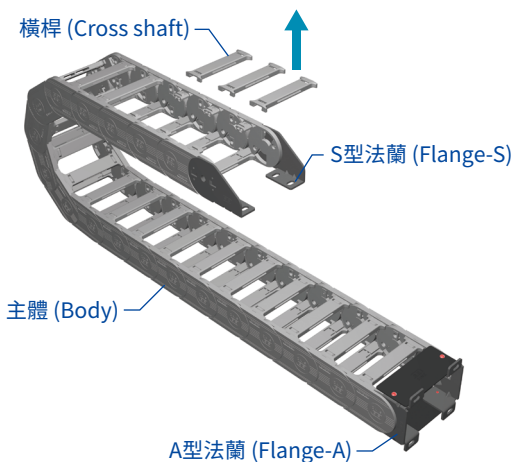

番號		尺寸表 (採一般公差) Specification (Approx) mm							重量
TYPE	A	B	C	D	節距	彎曲半徑(實質高度 Hs) Bending Radius(Real Height Hs)			kg/M
					Pitch	R (Hs)	R (Hs)	R (Hs)	
I	127	84	100	56	92	150 (414)	225 (564)	300 (714)	2.97
II	177	84	150	56	92	150 (414)	225 (564)	300 (714)	3.41
III	227	84	200	56	92	150 (414)	225 (564)	300 (714)	3.74
IV	277	84	250	56	92	150 (414)	225 (564)	300 (714)	4.07
V	327	84	300	56	92	150 (414)	225 (564)	300 (714)	4.40
VI	377	84	350	56	92	150 (414)	225 (564)	300 (714)	4.73
VII	427	84	400	56	92	150 (414)	225 (564)	300 (714)	4.95
VIII	527	84	500	56	92	150 (414)	225 (564)	300 (714)	5.72

SQ403 重型封閉式鏈條護管 (護蓋可掀開)

SQ403 BAND CABLE CHAIN (Protection cover can be opened)



中華民國專利號碼：第I464334號
R.O.C.Patent No. : I464334

TYPE-SQ403

材質：

護管係工程塑鋼射出成型，法蘭係鋼板沖壓成型。

特長：

- (一) 耐蝕性佳，不變形。
- (二) 可承載重壓。
- (三) 護管之長度可任意增長或減短。
- (四) 保養內部管線時，可隨即打開護蓋作業。
- (五) 以「不夾鐵屑」之功能設計，容易擦拭清理。

說明：

- a. 護蓋能開啟。
- b. 適重負載及中長行程之游動。
- c. 適用於電腦機床、龍門搪銑床、綜合加工機、機場空橋、水庫閘門、自動倉儲及產業機械等。

Material:

The Cable chain is injected with polyester, The flange is made of stamped steel plate.

Advantages:

- (1) Good corrosion resistance, deformation free.
- (2) Heavy duty .
- (3) Adjustable length.
- (4) Open protection lid for maintenance.
- (5) Special design that doesn't trap metal chips for easy cleaning.

Direction:

- a. Protection cover is unsealed.
- b. Apply to heavy carrying capacity and middle-long movement.
- c. Apply to computer controlled machine tool, milling planner, machining center, airspace flyover, reservoir strobe, automatic warehouse, and industrial machinery.

護蓋 (Protection cover)

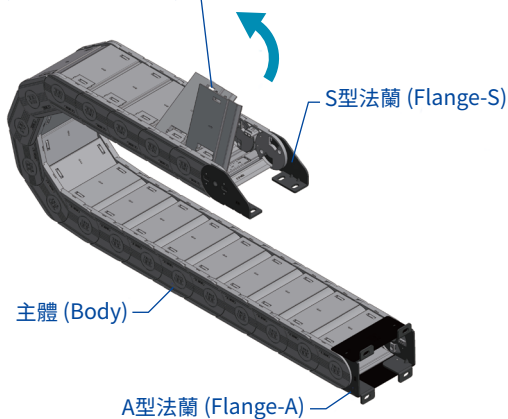

護蓋可掀開
(Protection cover can be opened)

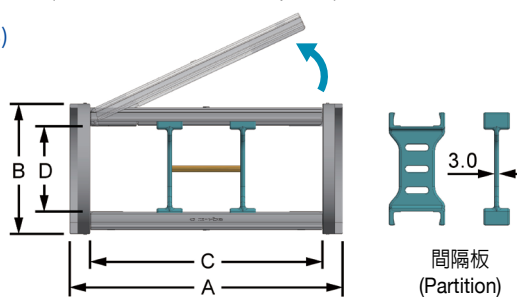

載重負荷曲線圖

Carrying capacity graph

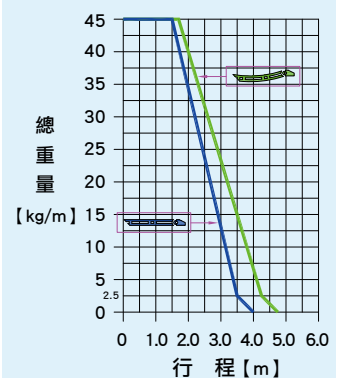

尺寸表 (採一般公差) Specification (Approx) mm

番號 TYPE	尺寸 (mm)				節距 Pitch	彎曲半徑(實質高度 Hs) Bending Radius(Real Height Hs)			重量 kg/M
	A	B	C	D		R (Hs)	R (Hs)	R (Hs)	
I	127	84	100	56	92	150 (414)	225 (564)	300 (714)	3.85
II	177	84	150	56	92	150 (414)	225 (564)	300 (714)	4.40
III	227	84	200	56	92	150 (414)	225 (564)	300 (714)	5.06
IV	277	84	250	56	92	150 (414)	225 (564)	300 (714)	5.83

SQ402、SQ403 結構功能、法蘭型式及裝置方法

SQ402、SQ403 STRUCTURE FUNCTION, FLANGE TYPE & CABLE FLANGE ARRANGEMENTS

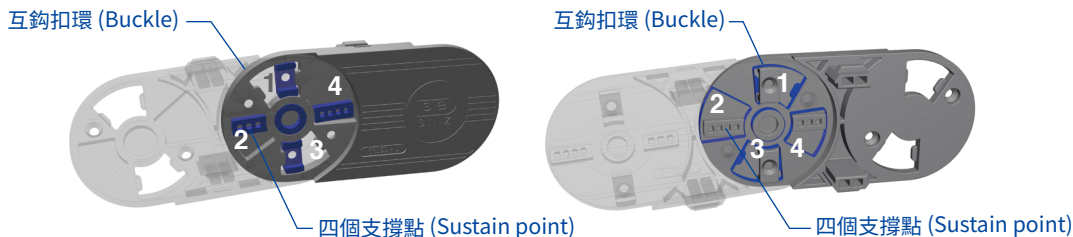

- 結構功能：設計四個受力支撐點及兩個互鈎扣環，可增加抗拉及抗扭，相對可倍增承載負荷。
Structure function : Four pressure supporting point and two bent coupling lock design, to increase anti pressure and anti torque and also increase carrying capacity exponentially.

S型法蘭 FLANGE-S

S型法蘭有兩款：(1) 標準型 (2) 排線夾型 (排線夾型規範請參閱第36、37頁)

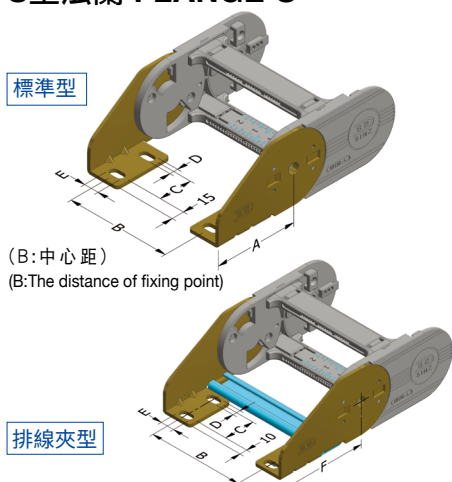

番號 TYPE	尺寸 Dimension(mm)							重量 Weight g/pc			
	A	B	C	D	E	F(m)	F(f)	公端(m)		母端(f)	
								標準	排線	標準	排線
I	100	75	40	10	18	104	118	268	266	352	373
II	100	125	40	10	18	104	118	268	266	352	373
III	100	175	40	10	18	104	118	268	266	352	373
IV	100	225	40	10	18	104	118	268	266	352	373
V	100	275	40	10	18	104	118	268	266	352	373
VI	100	325	40	10	18	104	118	268	266	352	373
VII	100	375	40	10	18	104	118	268	266	352	373
VIII	100	475	40	10	18	104	118	268	266	352	373

A型法蘭 FLANGE-A

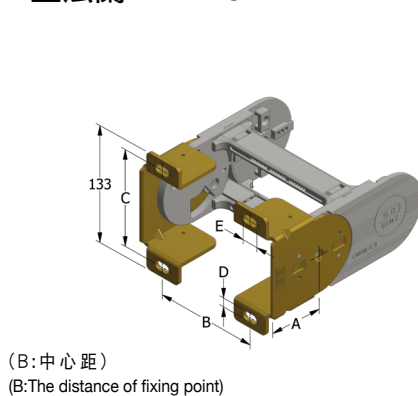

番號 TYPE	尺寸 Dimension(mm)					重量 Weight g/pc	
	A	B	C	D	E	公端(m)	母端(f)
I	61	65	110	10	18	346	438
II	61	115	110	10	18	346	438
III	61	165	110	10	18	346	438
IV	61	215	110	10	18	346	438
V	61	265	110	10	18	346	438
VI	61	315	110	10	18	346	438
VII	61	365	110	10	18	346	438
VIII	61	465	110	10	18	346	438

法蘭裝置方法 (Flange Arrangements)

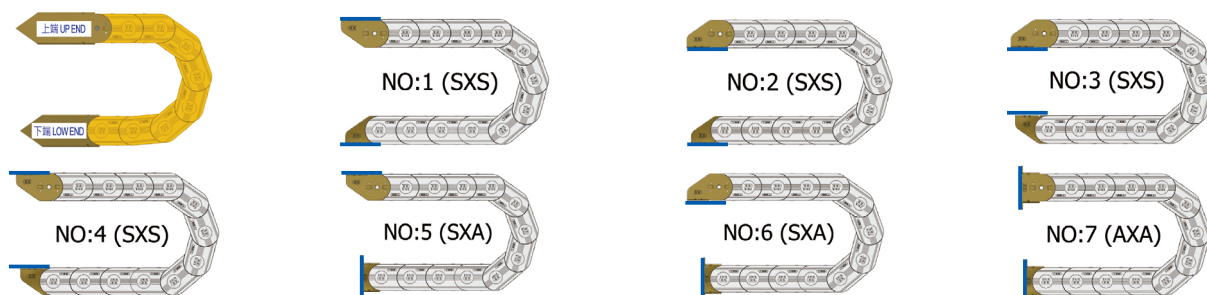

鏈條護管應用概念及長度計算方式，請參閱第011頁 Refer to page 011 for application concept of cable chain, length calculation.

購買鏈條護管時稱呼，請參閱第092頁 When buying cable chains, please refer to page 092.

□型桿開放式鏈條護管使用場所和型號 (□型桿可拆卸)

□-shaped rod open chain guard application places and models (□-shaped Cross shaft)

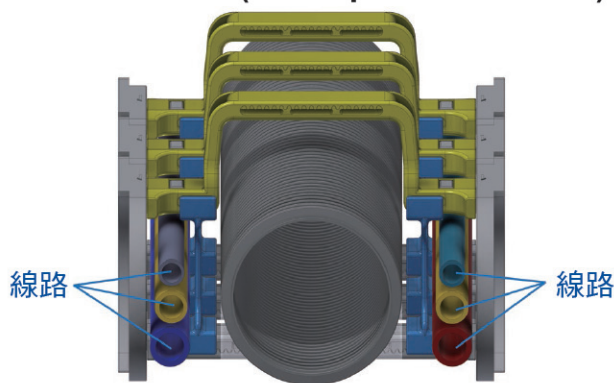
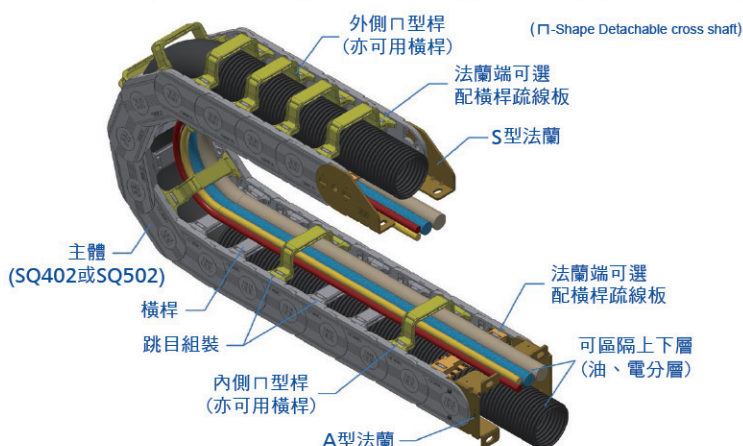

裝配較大型管線 (線路示意)

材質：
□型桿係工程塑鋼射出成型。

特長：

- (一) 耐蝕性佳，可承載重壓，不變形。
- (二) 可裝單側、雙側或者跳目裝。
- (三) 保養內部管線時，可隨即打開□型桿作業。

說明：

a. SQ401(SQ501)主體和法蘭部分尺寸請參考 SQ402(SQ502) II、III 護管相關尺寸表。

Material：
□-shaped rod system engineering plastic steel injection molding.

Advantages：

- (1) Good corrosion resistance, can bear heavy pressure without deformation.
- (2) Can be installed on one side, two sides or in a jumper.
- (3) When maintaining the internal pipeline, the □-shaped rod can be opened immediately for operation.

Direction：

a. For the dimensions of the SQ401 (SQ501) body and flange, please refer to the SQ402 (SQ502) II and III protective tube related dimension table..

SQ401 護管設計：

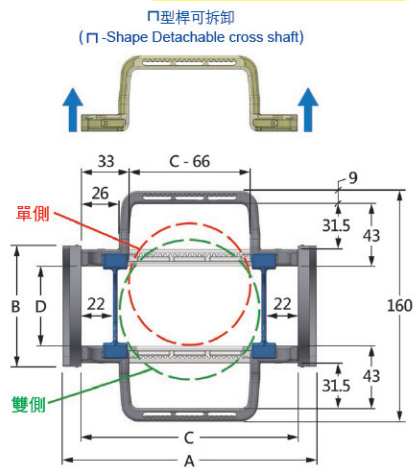

SQ501 護管設計：

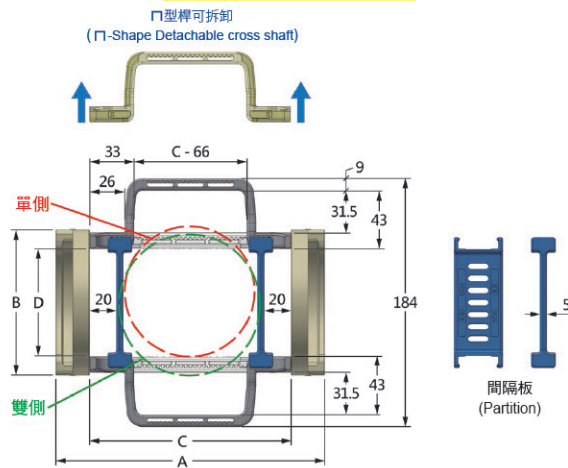

尺寸表 (採一般公差) Specification (Approx) mm

型號 Catalog	番號 No.	A	B	C	D	節距 Pitch	最大直徑值 Maximum diameter		重量 Weight
							單側 One side	雙側 Both sides	
SQ401	II	177	84	150	56	92	∅87	∅100	44.4
SQ401	III	227	84	200	56	92	∅92	∅136	55.8
SQ501	II	200	108	150	80	111	∅100	∅115	44.4
SQ501	III	250	108	200	80	111	∅120	∅156	55.8



標準疏線板

STANDARD THINNER BOARD

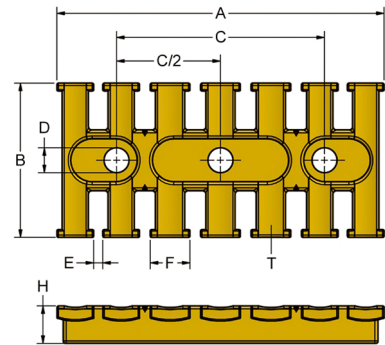
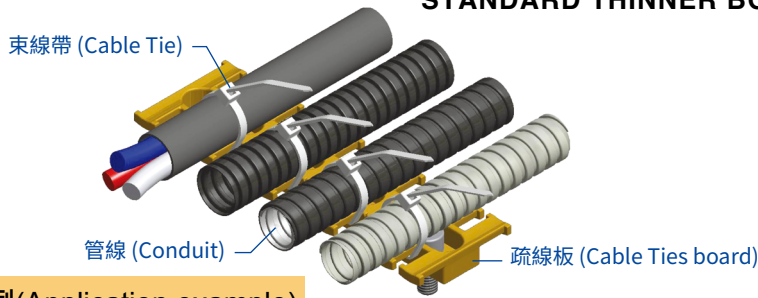

使用例(Application example)

- 廣泛用於鏈條護管法蘭之前端及末端。
Widely used at the front and end of the chain protection pipe flange.

型號 Catalog No.	番號 TYPE	A	B	C	尺寸 C/2	Dimension (mm) D	E	F	T	H
ASQTW010000000	I	88	50.6	55	-	8.2	3.0	12	6	12.3
ASQTW020000000	II	107	50.6	70	-	8.2	3.0~3.5	12~13	7	12.3
ASQTW030000000	III	157	50.6	115	-	8.2	3.0~3.6	12~13	10	12.3
ASQTW040000000	IV	207	50.6	168	84	8.2	3.0	12	14	12.3

橫桿疏線板

CROSSBAR THINNING BOARD

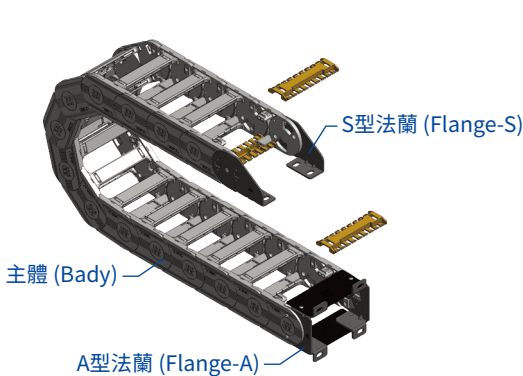

SQ402、SQ502

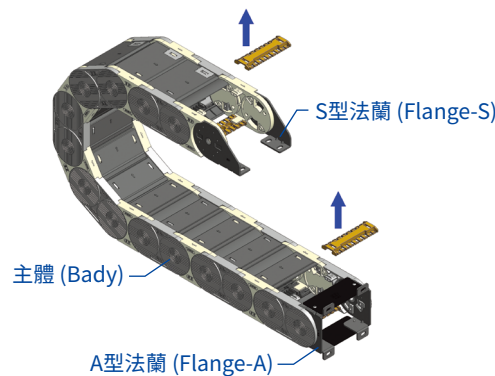

SQ403、SQ503

橫桿疏線板可拆卸
(Detachable cross shaft)

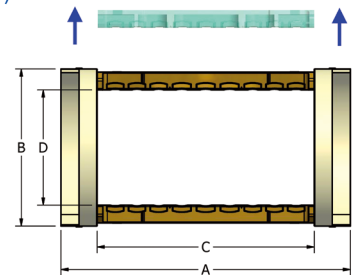

尺寸表 (採一般公差) Specification (Approx) mm									
型號 Catalog No.	番號 TYPE	A	B	C	D	節距 Pitch	彎曲半徑(實質高度 Hs) Bending Radius(Real Height Hs)		
							R (Hs)	R (Hs)	R (Hs)
SQ402 (SQ403)	I	127	84	100	56	92	150 (414)	225 (564)	300 (714)
SQ402 (SQ403)	II	177	84	150	56	92	150 (414)	225 (564)	300 (714)
SQ402 (SQ403)	III	227	84	200	56	92	150 (414)	225 (564)	300 (714)
SQ402 (SQ403)	IV	277	84	250	56	92	150 (414)	225 (564)	300 (714)
SQ502 (SQ503)	I	150	108	100	80	111	200 (538)	275 (688)	350 (838)
SQ502 (SQ503)	II	200	108	150	80	111	200 (538)	275 (688)	350 (838)
SQ502 (SQ503)	III	250	108	200	80	111	200 (538)	275 (688)	350 (838)
SQ502 (SQ503)	IV	300	108	250	80	111	200 (538)	275 (688)	350 (838)

SQ502 巨型開放式鏈條護管 (橫桿可拆卸)

SQ502 BAND CABLE CHAIN (Detachable cross shaft)



中華民國專利號碼：第I487855號
R.O.C.Patent No. : I487855

TYPE-SQ502

材質：

護管係工程塑鋼射出成型，法蘭係鋼板沖壓成型。

特長：

- (一) 耐蝕性佳，不變形。
- (二) 可承載重壓。
- (三) 護管之長度可任意增長或減短。
- (四) 保養內部管線時，可隨即打開橫桿作業。

說明：

- a. 承受重壓不變形，橫桿能拆卸。
- b. 適重負載及中長行程之游動。
- c. 適用於電腦機床、龍門搪銑床、綜合加工機、機場空橋、水庫閘門、自動倉儲及產業機械等。

Material:

The Cable chain is injected polyester. The flange is stamped steel sheet.

Advantages:

- (1) Good corrosion resistance, deformation free.
- (2) Heavy duty.
- (3) Adjustable length.
- (4) Open protection lid for interior cable maintenance.

Direction:

- a. Not easy to twist under pressure, Detachable cross shaft.
- b. Apply to heavy carrying capacity and middle-long movement.
- c. Apply to computer controlled machine tool, milling planner, machining center, airspace flyover, reservoir strobe, automatic warehouse, and industrial machinery.

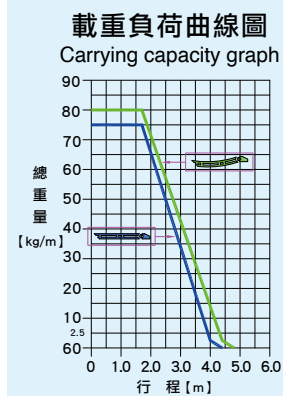
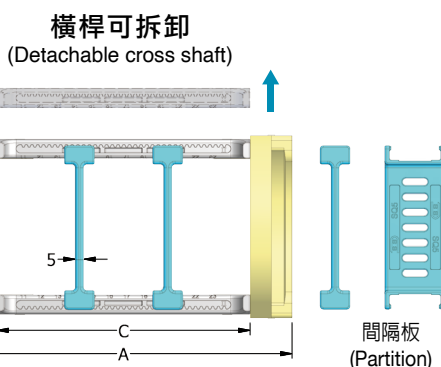
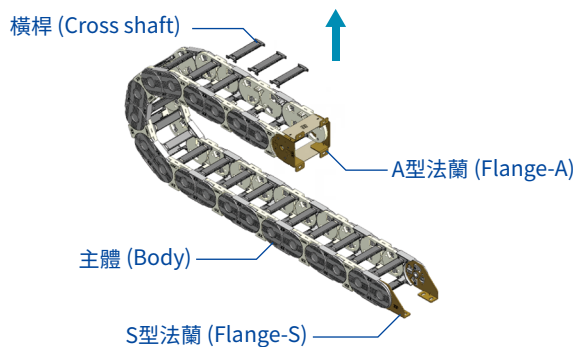

尺寸表 (採一般公差) Specification (Approx) mm									
番號 TYPE	節距				彎曲半徑(實質高度 Hs) Bending Radius (Real Height Hs)			重量 Weight kg/M	
	A	B	C	D	Pitch	R (Hs)	R (Hs)		R (Hs)
I	150	108	100	80	111	200 (538)	275 (688)	350 (838)	5.9
II	200	108	150	80	111	200 (538)	275 (688)	350 (838)	6.3
III	250	108	200	80	111	200 (538)	275 (688)	350 (838)	6.7
IV	300	108	250	80	111	200 (538)	275 (688)	350 (838)	7.0
V	350	108	300	80	111	200 (538)	275 (688)	350 (838)	7.3
VI	400	108	350	80	111	200 (538)	275 (688)	350 (838)	7.7
VII	450	108	400	80	111	200 (538)	275 (688)	350 (838)	8.0
VIII	550	108	500	80	111	200 (538)	275 (688)	350 (838)	8.6

SQ503 巨型封閉式鏈條護管 (護蓋可掀開)

SQ503 BAND CABLE CHAIN (Protection cover can be opened)

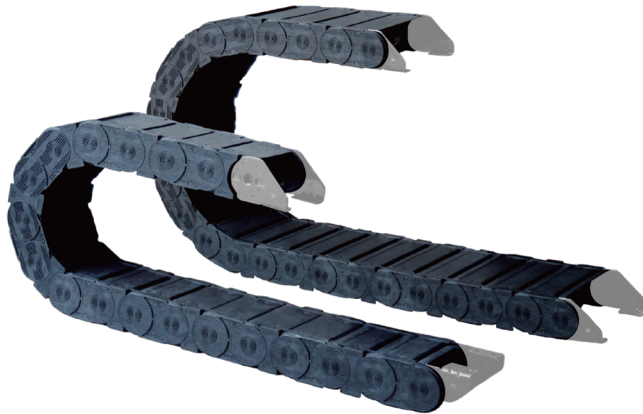

中華民國專利號碼：第I487855號
R.O.C.Patent No. : I487855

TYPE-SQ503

材質：

護管係工程塑膠射出成型，法蘭係鋼板沖壓成型。

特長：

- (一) 以「不夾鐵屑」之功能設計，容易擦拭清理。
- (二) 保養內部管線時，可隨即打開護蓋作業。
- (三) 耐蝕性佳，不變形。
- (四) 可承載重壓。
- (五) 護管之長度可任意增長或減短。

說明：

- a. 承受重壓不變形，護蓋能掀開。
- b. 適重負載及中長行程之游動。
- c. 適用於電腦機床、龍門搪銑床、綜合加工機、機場空橋、水庫閘門、自動倉儲及產業機械等。

Material:

The Cable chain is injected with polyester, The flange is made of stamped steel plate.

Advantages:

- (1) Special design that doesn't trap metal chips for easy cleaning.
- (2) Open protection lid for maintenance.
- (3) Good corrosion resistance, deformation free.
- (4) Heavy duty .
- (5) Adjustable length.

Direction:

- a. Not easy to twist under pressure, Protection cover can be opened.
- b. Apply to heavy carrying capacity and middle-long movement.
- c. Apply to computer controlled machine tool, milling planner, machining center, airspace flyover, reservoir strobe, automatic warehouse, and industrial machinery.

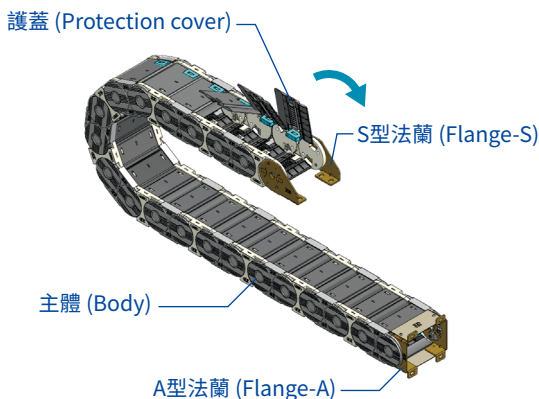

護蓋可掀開
(Protection cover can be opened)

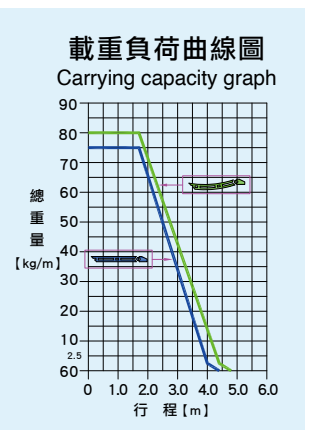
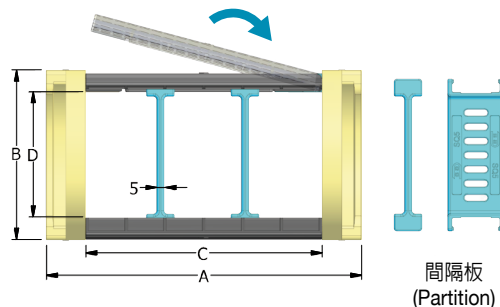

尺寸表 (採一般公差) Specification (Approx) mm

番號 TYPE	節距				彎曲半徑(實質高度 Hs) Bending Radius (Real Height Hs)			重量 Weight kg/M	
	A	B	C	D	Pitch	R (Hs)	R (Hs)		R (Hs)
I	150	108	100	80	111	200 (538)	275 (688)	350 (838)	6.6
II	200	108	150	80	111	200 (538)	275 (688)	350 (838)	7.2
III	250	108	200	80	111	200 (538)	275 (688)	350 (838)	7.9
IV	300	108	250	80	111	200 (538)	275 (688)	350 (838)	8.5

SQ502、SQ503 結構功能、法蘭型式及裝置方法

SQ502、SQ503 STRUCTURE FUNCTION, FLANGE TYPE & CABLE FLANGE ARRANGEMENTS



- 結構功能 : 設計四個受力支撐點，兩個互鈎扣環及旋轉導槽，可增加抗拉及抗扭，相對可倍增承載負荷。
- Structure function : Four pressure supporting point and two bent coupling lock design and Rotation guide channel, to increase anti pressure and anti torque and also increase carrying capacity exponentially.

S型法蘭 FLANGE-S

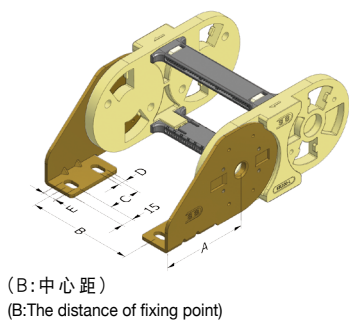

番號 TYPE	尺寸 Dimension(mm)					重量 Weight g/pc	
	A	B	C	D	E	公端(m)	母端(f)
I	110	84	40	10	18	370	488
II	110	134	40	10	18	370	488
III	110	184	40	10	18	370	488
IV	110	234	40	10	18	370	488
V	110	284	40	10	18	370	488
VI	110	334	40	10	18	370	488
VII	110	384	40	10	18	370	488
VIII	110	484	40	10	18	370	488

A型法蘭 FLANGE-A

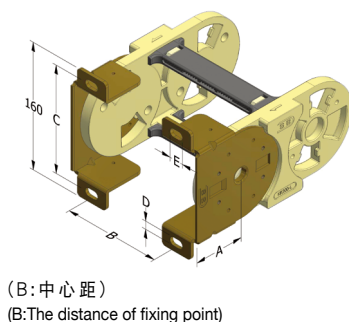

番號 TYPE	尺寸 Dimension(mm)					重量 Weight g/pc	
	A	B	C	D	E	公端(m)	母端(f)
I	64	73	136	10	18	443	574
II	64	123	136	10	18	443	574
III	64	173	136	10	18	443	574
IV	64	223	136	10	18	443	574
V	64	273	136	10	18	443	574
VI	64	323	136	10	18	443	574
VII	64	373	136	10	18	443	574
VIII	64	473	136	10	18	443	574

法蘭裝置方法 (Flange Arrangements)

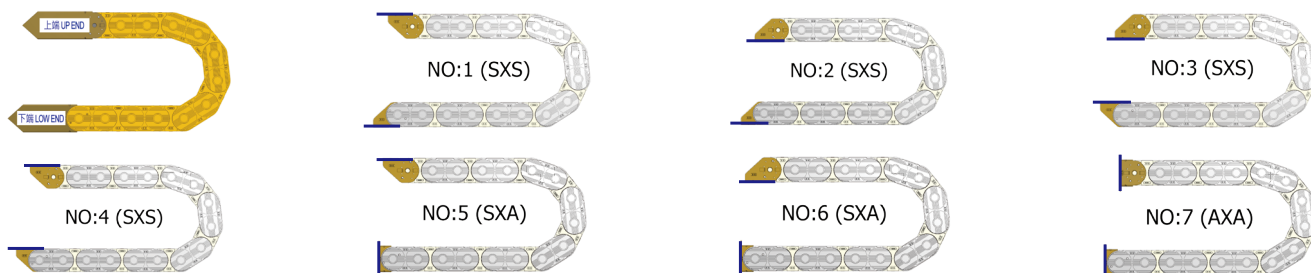

鏈條護管應用概念及長度計算方式，請參閱第011頁 Refer to page 011 for application concept of cable chain, length calculation. 購買鏈條護管時稱呼，請參閱第092頁 When buying cable chains, please refer to page 092.

SQ402、SQ502、SQ403、SQ503 拆卸組合操作方法及雙條護管疊層使用概略

SQ402、SQ502、SQ403、SQ503 COMBINATION OPEN, FLANGE TYPE & DOUBLE STROMATOLITH USING

SQ402、SQ502 橫桿拆卸及組合操作方法：Detach and combination operation of cross shaft

- 拆解工具為5mm寬一字形起子 (Dismantling with 5mm slotted screwdriver)

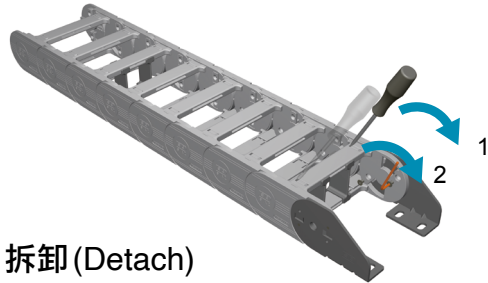

拆卸 (Detach)

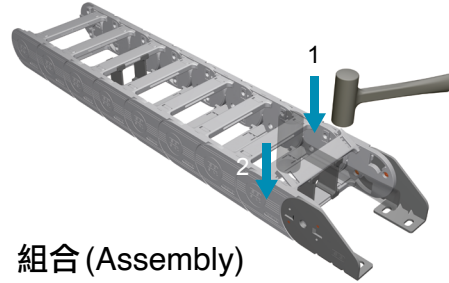

組合 (Assembly)

SQ403、SQ503 護蓋掀開及組合操作方法：Open and combination operation of protection cover

- 拆解工具為5mm寬一字形起子 (Dismantling with 5mm slotted screwdriver)

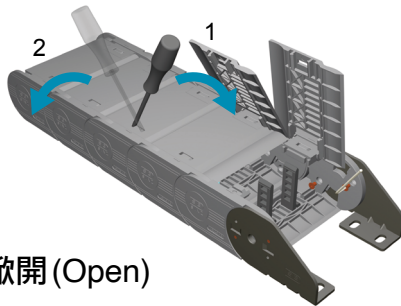

掀開 (Open)

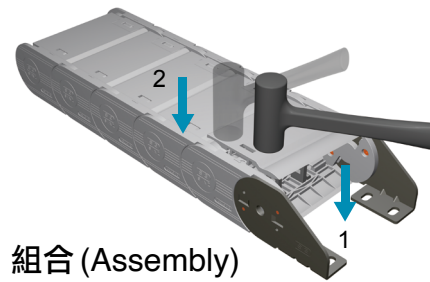

組合 (Assembly)

SQ402、SQ403-可設計雙條疊層使用：Design for double stromatolith using

倘若鏈條護管之安裝因空間受限，則可設計雙條護管疊層并用。

If the installation of cable chain is not available, please choose double stromatolith.

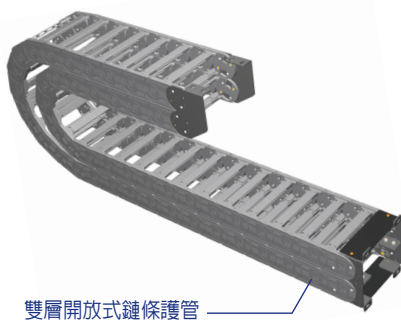

雙層開放式鏈條護管

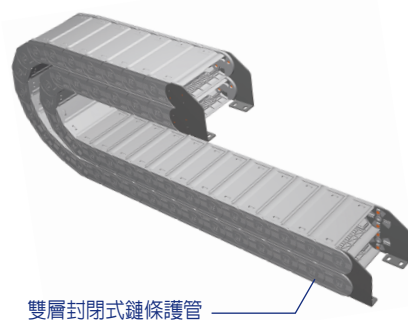

雙層封閉式鏈條護管



SQ402雙條疊層使用例：Application Example



SQ403雙條疊層使用例：Application Example

SQ301 方形游動護管 (標準型)

SQ301 CAPFLEX (Standard type)

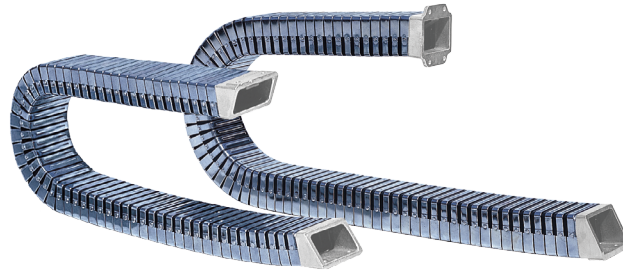

TYPE-SQ301

材質：

金屬上下壓片係SK7鋼板沖壓成型與方型塑鋼框鉚合組成，法蘭係鋁合金材質。

特長：

護管游動時，線條平順美觀，寂靜無聲。

說明：

- a. 護蓋不能打開。
- b. 適中負載及中行程之游動。
- c. 適用於搪銑床、電腦機床、綜合加工機及產業機械等。

Material:

The upper and lower plates are punched by riveted SK7 steel plate and square plastic steel frame. Flange plates are made of aluminum alloy.

Advantages:

Quiet and smooth motion with elegant flex line.

Direction:

- a. The protection cover is not able to turn on.
- b. Moderate load and movement.
- c. Apply to milling machine, computer controlled machine tool, machining center and industrial machinery.

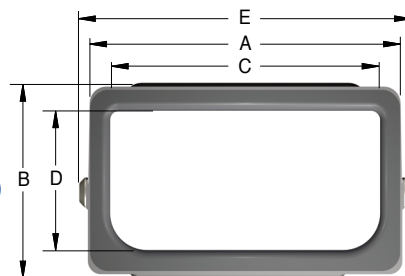
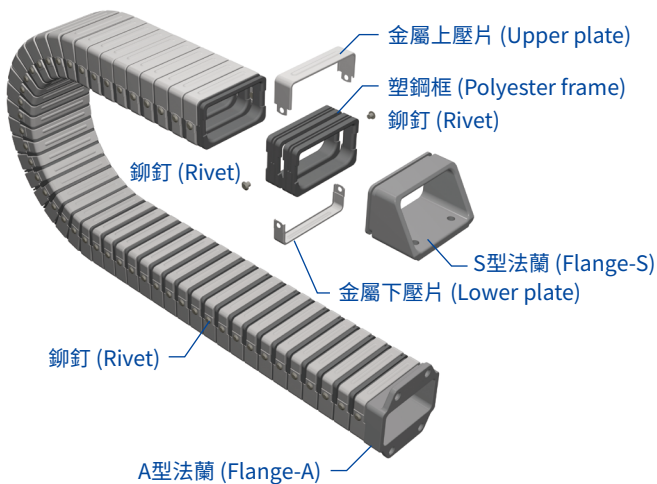

載重負荷曲線圖

Carrying capacity graph

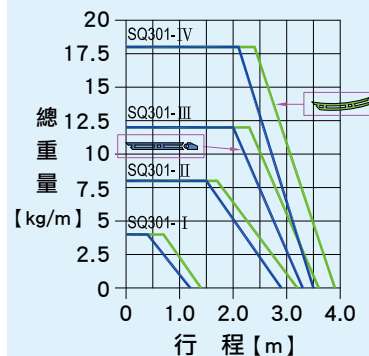

尺寸表 (採一般公差) Specification (Approx) mm

番號	節距					彎曲半徑(實質高度 Hs)				重量	
	A	B	C	D	E	Pitch	R (Hs)	R (Hs)	R (Hs)		R (Hs)
TYPE	A	B	C	D	E	Pitch	R (Hs)	R (Hs)	R (Hs)	R (Hs)	Weight kg/M
I	56	38	44	24	61	20	75 (213)	100 (263)	150 (363)	200 (463)	1.04
II	85	53	72	37.5	90	20	150 (378)	200 (478)	250 (578)	280 (638)	1.95
III	117	69	100	51	119	25	150 (399)	200 (499)	250 (599)	320 (739)	2.90
IV	126	93	105	71	129	25	220 (563)				3.70

SQ301 法蘭型式及裝置方法

SQ301 FLANGE TYPE & CABLE FLANGE ARRANGEMENTS

S型法蘭 FLANGE-S

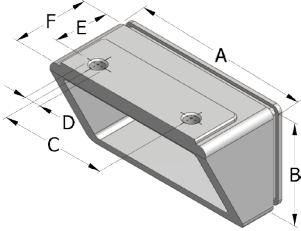

番號 TYPE	尺寸 Dimension (mm)						重量 Weight g/pc
	A	B	C	D	E	F	
I	56	36	22	7	31.5	43	92
II	85	51	50	7	32.5	45	149
III	117	66	70	9	39	51	295
IV	126	91	70	9	35	50	385

A型法蘭 FLANGE-A

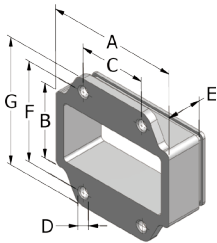

番號 TYPE	尺寸 Dimension (mm)							重量 Weight g/pc
	A	B	C	D	E	F	G	
I	56	36	18	7	19	55	73	76
II	85	51	45	7	26.5	70	87	152
III	117	66	60	9	31	90	112	295
IV	126	91	60	9	32	110	134	418

B型法蘭 FLANGE-B

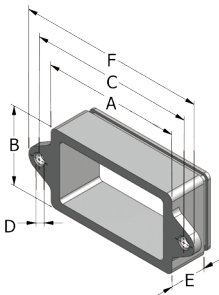

番號 TYPE	尺寸 Dimension (mm)						重量 Weight g/pc
	A	B	C	D	E	F	
I	56	36	75	7	19	92	69
II	85	51	105	7	26.5	122	129
III	117	66	140	9	31	161	275
IV	126	91	145	9	32	168	344

法蘭裝置方法 (Flange Arrangements)

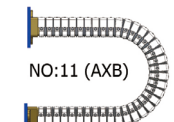
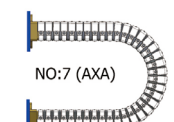
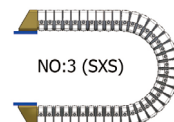
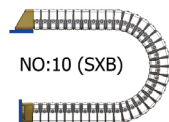
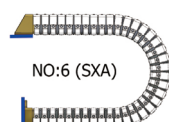
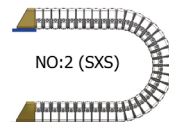
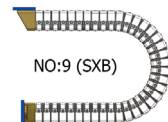
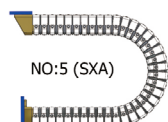
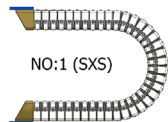
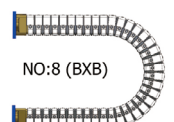
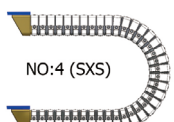
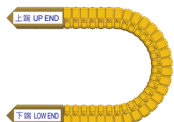

鏈條護管應用概念及長度計算方式，請參閱第011頁 Refer to page 011 for application concept of cable chain, length calculation.

購買鏈條護管時稱呼，請參閱第092頁 When buying cable chains, please refer to page 092.

SQ902 重承載開放式金屬鏈條護管 (橫桿可拆卸)

SQ902 HEAVY-LOAD METAL CABLE CHAIN (Detachable cross shaft)

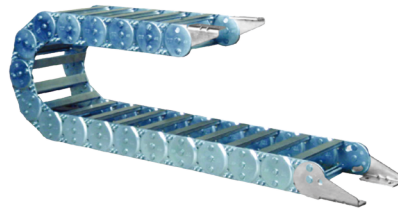

中華民國專利號碼：第M395959號
R.O.C. Patent No. : M395959

TYPE-SQ902

材質：

- (一) 主體與法蘭係鋼板沖壓成型。
- (二) 橫桿係鋁合金擠製成型。
- (三) 插銷係合金鋼擠製成型。
- (四) 螺絲為內六角合金鋼螺絲 (具防鬆效果)。
- (五) C型扣環為鋼質材料。

特長：

- (1) 鋼質材料堅韌耐磨，不變形不脫節。
- (2) 可承重荷，係專為長距離游動之護管設計。
- (3) 護管之長度可任意增長或減短。
- (4) 護管內容寬度(尺寸表：E)，可依實際需求而訂製，最寬寬度可達600 mm。
- (5) 保養內部管線時，可隨即拆開橫桿作業。

說明：

- a. 可承重壓不變形。
- b. 適重負荷及長行程之游動。
- c. 高穩定性，使用壽命長。
- d. 可作短距離懸空側裝(無支撐)。
- e. 適用於巨型機床、輸送空橋、長距閘門及自動化整廠設備等。

Material:

- (1) The body and flange are punched by steel plate.
- (2) Booms are pressed by aluminum alloy.
- (3) Pins are pressed by alloy steel.
- (4) Hexagonal screws are applied (looseness resistance).
- (5) C-type fasteners are made of steel.

Advantages:

- (1) The steel materials can be tough and flexible without distortion and link.
- (2) The heavy-load sleeve is designed for long-stroke movement.
- (3) The length of a sleeve can be increased or decreased.
- (4) The inner width of a sleeve (Specification:E) can be customized according to the actual requirements. The maximum width can be up to 600 mm.
- (5) Booms can be removed when maintaining the interior conduits.

Direction:

- a. Heavy load without distortion
- b. It is suitable for heavy load and long-stroke movement.
- c. High stability and long lifetime.
- d. Installation on the suspension side (no support).
- e. It is suitable for large machine tools, conveyance bridge, long-distance gate and automation equipment.

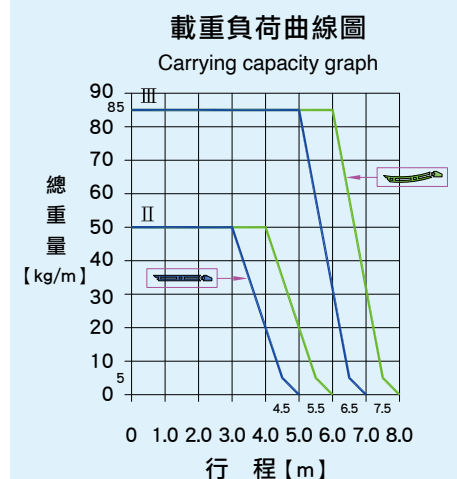
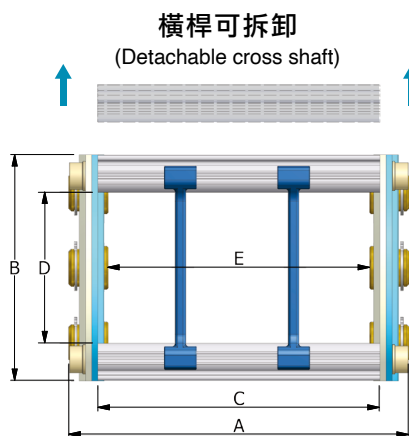
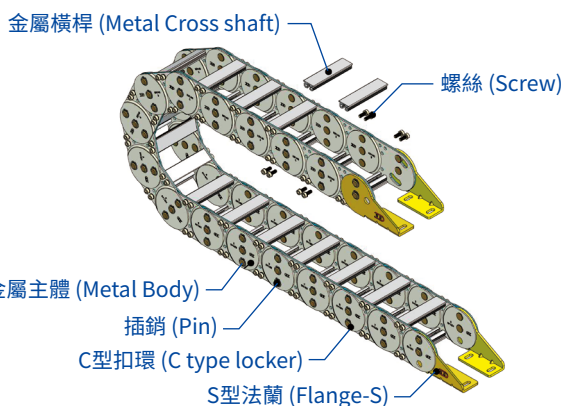

		尺寸表 (採一般公差) Specification (Approx) mm														
番號	節距	彎曲半徑(實質高度 Hs) Bending Radius(Real Height Hs)												重量 Weight kg/M		
		A	B	C	D	E	Pitch	R (Hs)	R (Hs)	R (Hs)	R (Hs)	R (Hs)	R (Hs)		R (Hs)	
I	C+20	68 (客製寬度)	40	C-7	86	100 (310)	150 (410)	200 (510)	250 (610)	300 (710)						8.8 (開發中)
II	C+22	84 (客製寬度)	56	C-8	95	140 (414)	200 (534)	250 (634)	300 (734)	350 (834)	400 (934)					11.5
III	C+24	103 (客製寬度)	75	C-9	125	145 (450)	200 (560)	250 (660)	300 (760)	350 (860)	400 (960)	500 (1160)				14.6

SQ903 重承載封閉式金屬鏈條護管 (護蓋可拆卸)

SQ903 HEAVY-LOAD METAL CABLE CHAIN (Protection cover can be opened)

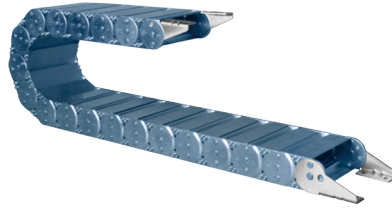

中華民國專利號碼：第M395959號
R.O.C. Patent No. : M395959

TYPE-SQ903

材質：

- (一) 主體與法蘭係鋼板沖壓成型。
- (二) 護蓋係鋁合金擠製成型。
- (三) 插銷係合金鋼擠製成型。
- (四) 螺絲為內六角合金鋼螺絲 (具防鬆效果)。
- (五) C型扣環為鋼質材料。

特長：

- (1) 鋼質材料堅韌耐磨，不變形不脫節。
- (2) 可承重荷，係專為長距離游動之護管設計。
- (3) 護管之長度可任意增長或減短。
- (4) 護管內容寬度(尺寸表：E)，可依實際需求而訂製，最寬寬度可達600mm。
- (5) 保養內部管線時，可隨即拆開護蓋作業。
- (6) 以「不夾鐵屑」之功能設計，容易擦拭清理。

說明：

- a. 可承重壓不變形。
- b. 適重負荷及長行程之游動。
- c. 高穩定性，使用壽命長。
- d. 可作短距離懸空側裝(無支撐)。
- e. 可用於高熱鐵屑場所。
- f. 適用於巨型機床、輸送空橋、長距閘門及自動化整廠設備等。

Material:

- (1) The body and flange are punched by steel plate.
- (2) Booms are pressed by aluminum alloy.
- (3) Pins are pressed by alloy steel.
- (4) Hexagonal screws are applied (looseness resistance).
- (5) C-type fasteners are made of steel.

Advantages:

- (1) The steel materials can be tough and flexible without distortion and link.
- (2) The heavy-load sleeve is designed for long-stroke movement.
- (3) The length of a sleeve can be increased or decreased.
- (4) The inner width of a sleeve (Specification:E) can be customized according to the actual requirements. The maximum width can be up to 600 mm.
- (5) Booms can be removed when maintaining the interior conduits.
- (6) Special design that doesn't trap metal chips for easy cleaning.

Direction:

- a. Heavy load without distortion
- b. It is suitable for heavy load and long-stroke movement.
- c. High stability and long lifetime.
- d. Installation on the suspension side (no support).
- e. Can be applied to a place where the high temperature and iron filings occur.
- f. It is suitable for large machine tools, conveyance bridge, long-distance gate and automation equipment.

金屬護蓋 (Metal Protection cover)

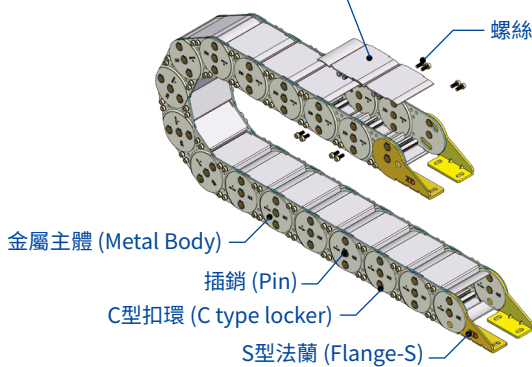

護蓋可拆卸

(Protection cover can be removed)

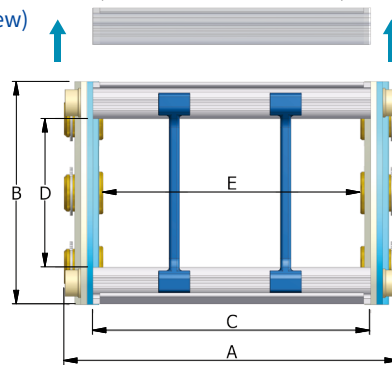

載重負荷曲線圖

Carrying capacity graph

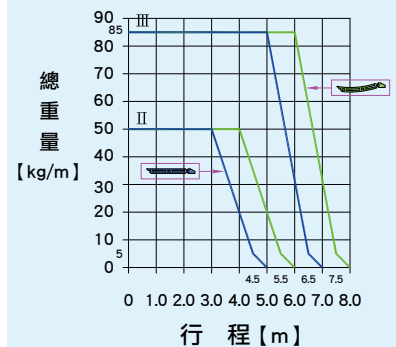

尺寸表 (採一般公差) Specification (Approx) mm

番號 TYPE	節距					彎曲半徑(實質高度 Hs) Bending Radius(Real Height Hs)					重量 Weight kg/M		
	A	B	C	D	E	Pitch	R (Hs)	R (Hs)	R (Hs)	R (Hs)		R (Hs)	
I	C+20	68 (客製寬度)	40	C-7	86	86	100 (310)	150 (410)	200 (510)	250 (610)	300 (710)	9.7 (開發中)	
II	C+22	84 (客製寬度)	56	C-8	95	95	140 (414)	200 (534)	250 (634)	300 (734)	350 (834)	400 (934)	12.4
III	C+24	103 (客製寬度)	75	C-9	125	125	200 (560)	250 (660)	300 (760)	350 (860)	400 (960)	500 (1160)	17.7

SQ902、SQ903 法蘭型式

SQ902、SQ903 FLANGE TYPE

S型法蘭(FLANGE-S)
(TYPE - I)

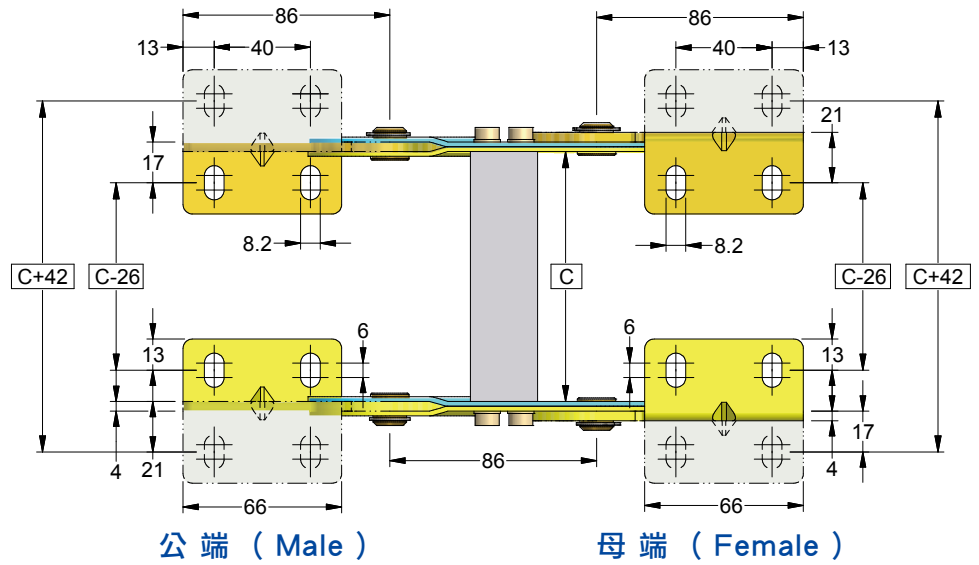

S型法蘭(FLANGE-S)
(TYPE - II)

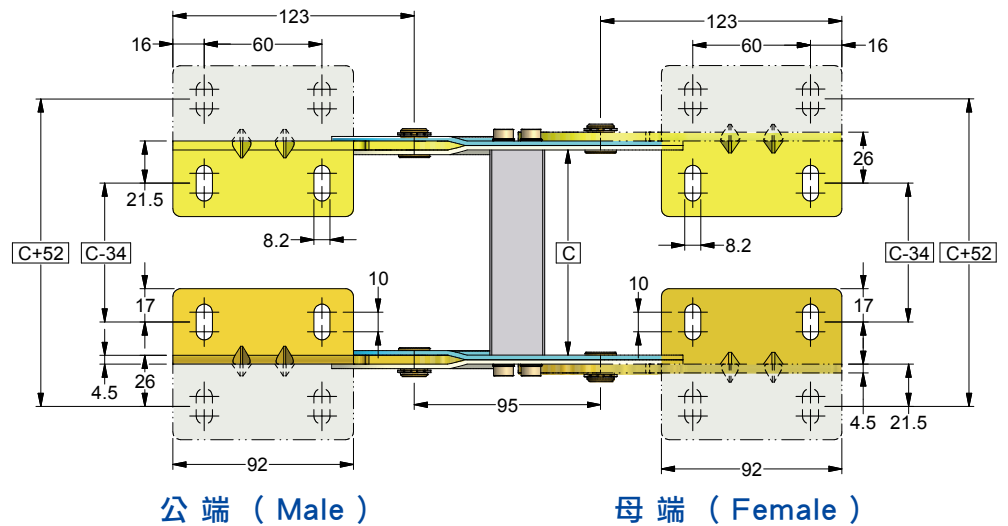

S型法蘭(FLANGE-S)
(TYPE - III)

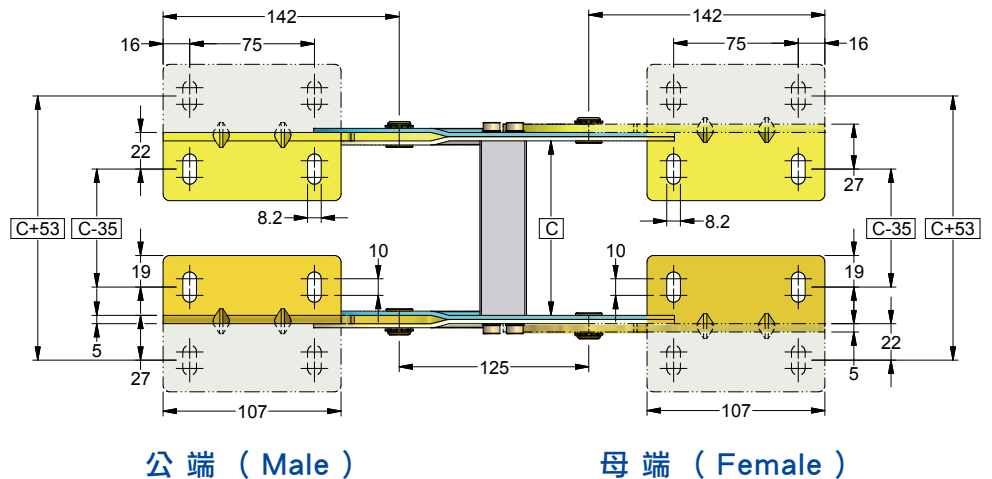

■ C : 訂製護管寬度 (客製寬度)

C : indicates the customized width.

SQ902、SQ903 隔板及法蘭裝置方法

SQ902、SQ903 PARTITION & FLANGE ARRANGEMENTS

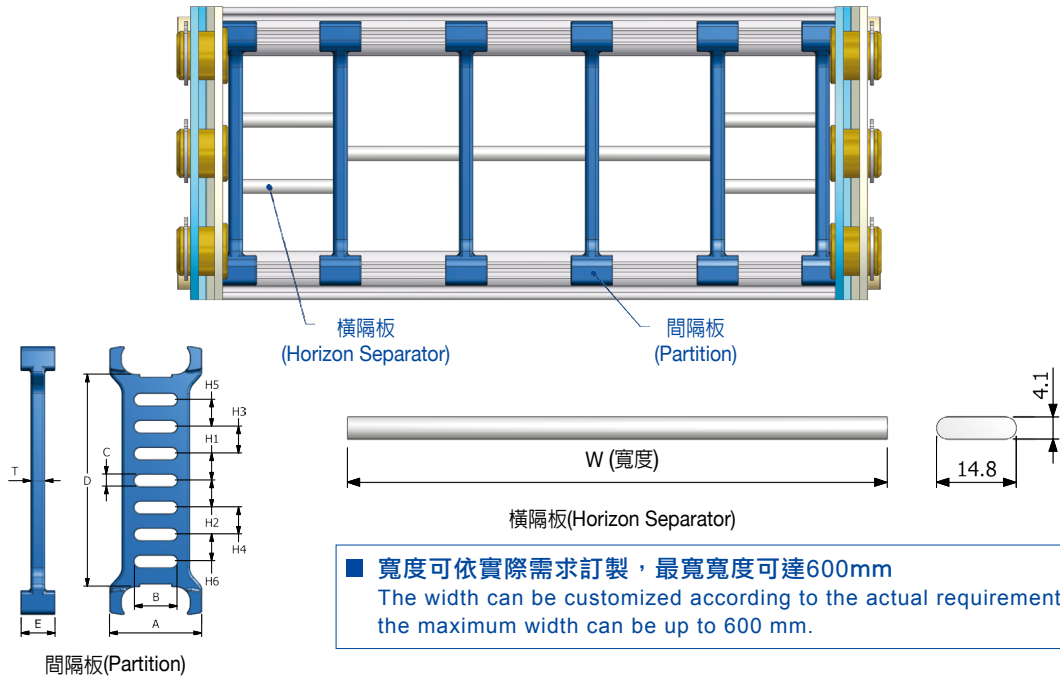

間隔板尺寸表 (採一般公差) Partition Specification (Approx) mm

番號 TYPE	A	B	C	D	E	T	H1	H2	H3	H4	H5	H6
I	32.5	15	4.2	40	12	4	9.5	9.5	-	-	-	-
II	32.5	15	4.2	56	12	4	9.5	9.5	9.5	9.5	-	-
III	32.5	15	4.2	75	12	5	9.5	9.5	9.5	9.5	9.5	9.5

法蘭裝置方法 (Flange Arrangements)

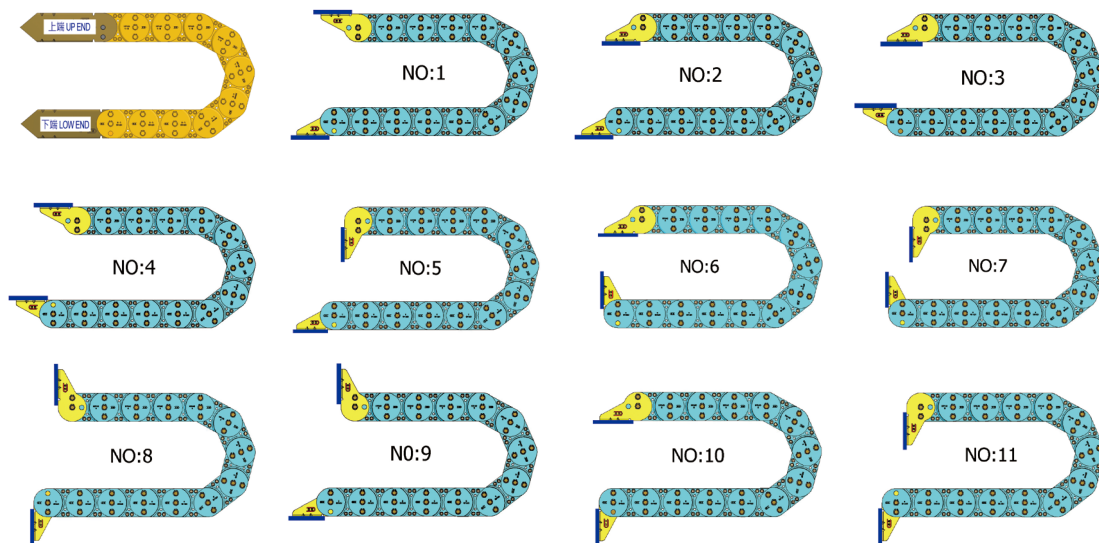

鏈條護管應用概念及長度計算方式，請參閱第011頁 Refer to page 011 for application concept of cable chain, length calculation.

購買鏈條護管時稱呼，請參閱第092頁 When buying cable chains, please refer to page 092.

排線夾

CLAMP HOUSING

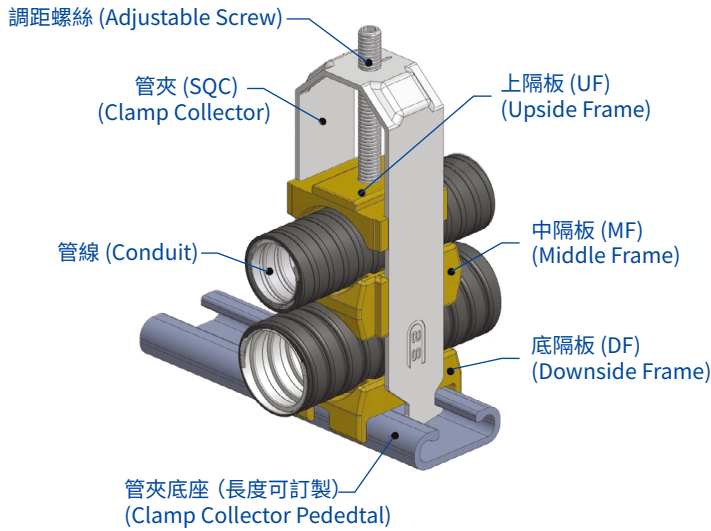

TYPE-SQC

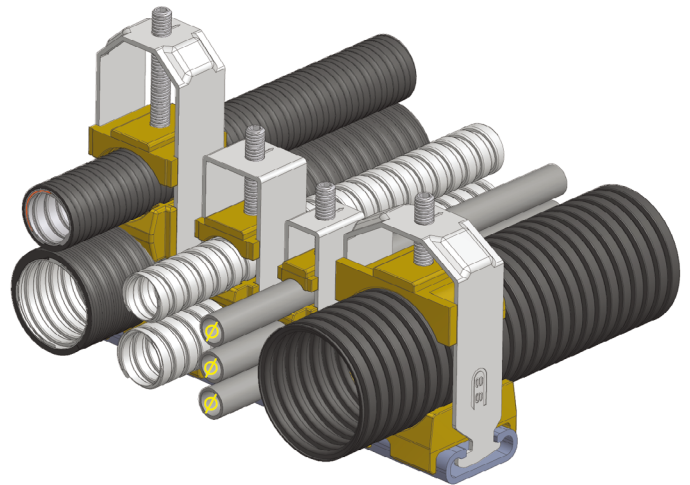

使用例 (Application example)

材質：

- (一) 管夾底座係鋁合金擠製成型。
- (二) 管夾係S50C鋼板衝壓成型。
- (三) 上隔板、中隔板、底隔板係塑鋼射出成型。
- (四) 調距螺絲係合金鋼與鐵片加工鉚合組成。

特長：

- (1) 可將管線牢牢固定。
- (2) 管夾底座之長度，可依所需之長度訂製。
- (3) 管夾有7種標準規格，可依需求配用。
- (4) 安裝迅速便捷，縮減工時。

說明：

- a. 適用於鏈條護管之管線固定。
- b. 適用於水電管線之固定。

Material:

- (1) Clamp base is pressed by aluminum alloy.
- (2) Clamp is cast by S50C steel plate.
- (3) The upper, medium and lower partition boards are ejected by plastic steel.
- (4) Pitch screw consists of riveted alloy steel and iron sheet.

Advantages:

- (1) Tightly fix pipes.
- (2) The length of clamp base can be customized.
- (3) Seven types of tube clamp can be selected.
- (4) Quickly and conveniently install to reduce work hours.

Direction:

- a. Suitable to fix cable chain.
- b. Suitable to fix water and electricity conduits.

安裝示意圖 Installation Drawing



- 管夾、隔板及管線定位後，再將調距螺絲鎖緊即可。
Adjust pitch screw to lock after clamp housing, vertical separator divider and tubes are positioned.
- 廣泛用於管路之定位及排列。
Widely used for positioning and arrangement of pipelines.

排線夾型式及配置方法

CLAMP HOUSING TYPE & INSTALLATION METHOD

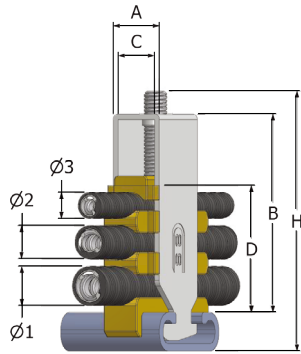

TYPE-SQC10
(線徑≤10mm)

尺寸 Dimension (mm)									
型號	料別簡稱	管線排層	適用線徑	{線徑總合}	管夾外寬	管夾外高	管夾內寬	管夾內限高	總高
TYPE	Identification Marking	Layout	ø [mm]	Total ø [mm]	A	B	C	D	H
SQC10S (標準型)	10A	1	6~10	(06~10)	14	38.5	10.5	33	60
	10B	2	6~10	(12~16)	14	38.5	10.5	33	63
	10C	2	6~10	(16~20)	14	38.5	10.5	33	63
SQC10L (加高型)	10D	3	6~10	(18~22)	14	52.5	10.5	47	73
	10E	3	6~10	(22~26)	14	52.5	10.5	47	73
	10F	3	6~10	(26~30)	14	52.5	10.5	47	73
	10G	4	6~10	(24~30)	14	52.5	10.5	47	73

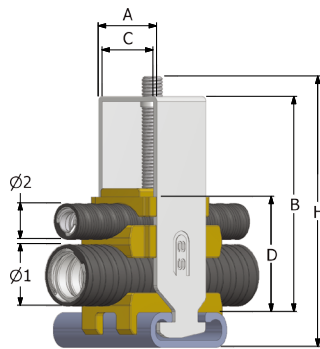

TYPE-SQC20
(線徑≤20mm)

尺寸 Dimension (mm)									
型號	料別簡稱	管線排層	適用線徑	{線徑總合}	管夾外寬	管夾外高	管夾內寬	管夾內限高	總高
TYPE	Identification Marking	Layout	ø [mm]	Total ø [mm]	A	B	C	D	H
SQC20S (標準型)	20A	1	10~15	(10~15)	24	38.5	20.5	33	60
	20B	1	15~20	(15~20)	24	38.5	20.5	33	60
SQC20L (加高型)	20C	2	10~20	(20~25)	24	62.5	20.5	57	87
	20D	2	10~20	(25~30)	24	62.5	20.5	57	87
	20E	2	10~20	(30~35)	24	62.5	20.5	57	87
	20F	2	10~20	(35~40)	24	62.5	20.5	57	87
	20G	3	10~20	(30~36)	24	62.5	20.5	57	87
	20H	3	10~20	(36~40)	24	62.5	20.5	57	87

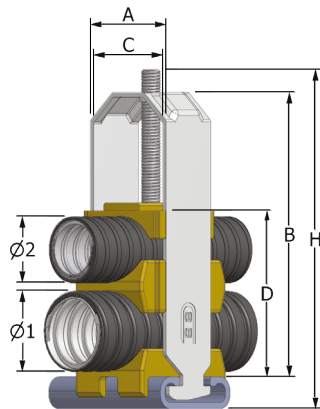

TYPE-SQC30
(線徑≤30mm)

尺寸 Dimension (mm)									
型號	料別簡稱	管線排層	適用線徑	{線徑總合}	管夾外寬	管夾外高	管夾內寬	管夾內限高	總高
TYPE	Identification Marking	Layout	ø [mm]	Total ø [mm]	A	B	C	D	H
SQC30S (標準型)	30A	1	20~25	(20~25)	34	56.5	30.5	47	80
	30B	1	25~30	(25~30)	34	56.5	30.5	47	80
SQC30L (加高型)	30C	2	20~30	(40~45)	34	90.5	30.5	81	113
	30D	2	20~30	(45~50)	34	90.5	30.5	81	113
	30E	2	20~30	(50~55)	34	90.5	30.5	81	113
	30F	2	20~30	(55~60)	34	90.5	30.5	81	113
	30G	3	20~30	(56~61)	34	90.5	30.5	81	113

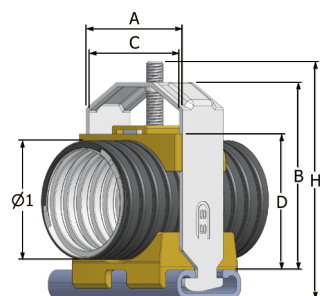

TYPE-SQC43
(線徑≤43mm)

尺寸 Dimension (mm)									
型號	料別簡稱	管線排層	適用線徑	{線徑總合}	管夾外寬	管夾外高	管夾內寬	管夾內限高	總高
TYPE	Identification Marking	Layout	ø [mm]	Total ø [mm]	A	B	C	D	H
SQC43S (標準型)	43A	1	30~34	(30~34)	47	64.5	43.5	58.5	84
	43B	1	34~39	(34~39)	47	64.5	43.5	58.5	84
	43C	1	39~43	(39~43)	47	64.5	43.5	58.5	84

■ {線徑總和}: 是指管夾內所有管線外徑之總和
{Sum of tube diameter}: The sum of outside diameter from all tubing by the clamp collector.

SQ833 封閉式鏈條護管 (護蓋可掀開 | 標準型)

SQ833 CABLE CHAIN (Protection cover can be opened | Standard type)

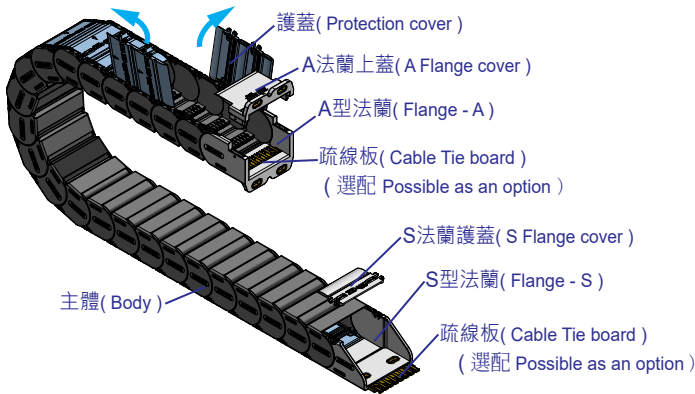

護蓋可向左或右掀開
(Protection cover can be opened)

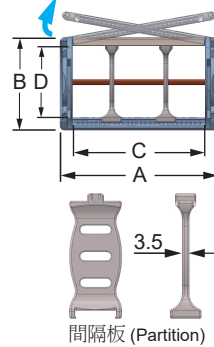

發明專利號碼: I702764

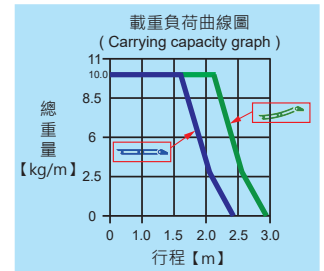

材質：
護管與法蘭係工程塑膠射出成型。

- 特長：
- (一) 以「不夾鐵屑」之功能設計，容易擦拭清理。
 - (二) 護管游動時平順美觀。
 - (三) 剛性強韌不變形。
 - (四) 護管之長度可任意增長或減短。
 - (五) 保養內部管線時，可隨即掀開護蓋施工。

- 說明：
- a. 護蓋能開啟。
 - b. 適中負載及中行程之游動。
 - c. 適用於電腦機床、龍門搪銑床、綜合加工機、自動倉儲、停車塔及產業機械等。

Material:
The Cable chain and flange are injected polyester.

- Advantages:
- (1) Special design that doesn't trap metal chips for easy cleaning.
 - (2) Quiet and smooth motion with elegant flex line.
 - (3) Hing rigidity, no deformation.
 - (4) Adjustable length.
 - (5) Open protection lid for maintenance.

- Direction:
- a. Protection cover can be opened.
 - b. Moderate load and movement.
 - c. Apply to computer machine tools, milling planner, machining center, automatic warehouse, parking tower, industrial machinery etc.

尺寸表 (採一般公差) Specification (Approx) mm

番號 TYPE	節距				彎曲半徑 (實質高度 Hs) Bending Radius (Real Height Hs)					重量 Weight kg/M	
	A	B	C	D	Pitch	R (Hs)	R (Hs)	R (Hs)	R (Hs)		R (Hs)
I	119	70	100	54	60	100 (295)	150 (395)	200 (495)	250 (595)	300 (695)	2.4

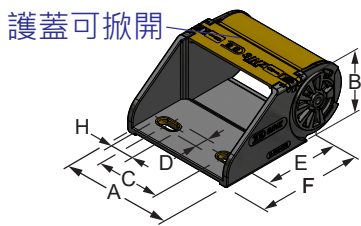

S 型法蘭 FLANGE-S

尺寸 Dimension (mm)								重量 Weight g/pc (f)	
A	B	C	D	E(m)(f)	F(m)(f)	H		(m)	(f)
119	70	71	9	85	110	20		244	224

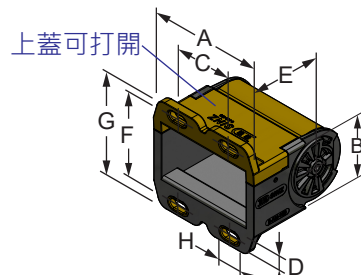

A 型法蘭 FLANGE-A

尺寸 Dimension (mm)								重量 Weight g/pc (f)	
A	B	C	D	E(m)(f)	F	G	H	(m)	(f)
119	70	61	9	85	90	110	20	297	274

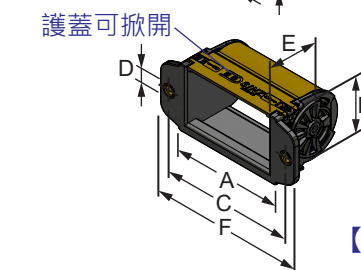

B 型法蘭 FLANGE-B

尺寸 Dimension (mm)						重量 Weight g/pc (f)	
A	B	C	D	E(m)(f)	F	(m)	(f)
119	70	141	9	48	162	156.4	140.4

法蘭裝置方法 (Flange Arrangements)

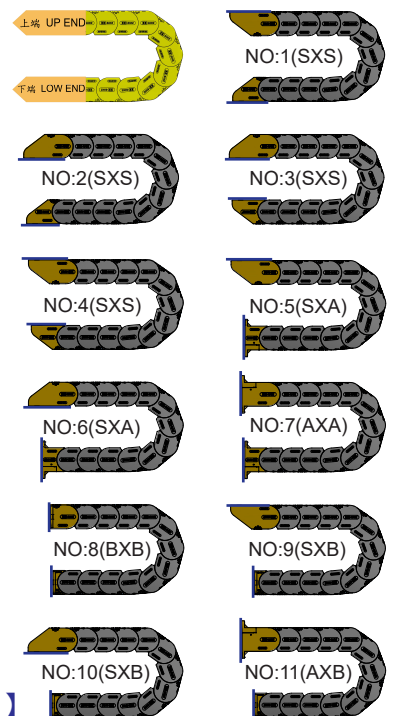

【另備有長行程護管，如有需求，請洽台中營業部業務人員】

鏈條護管使用範例

OPERATING CASES OF CABLE CHAIN

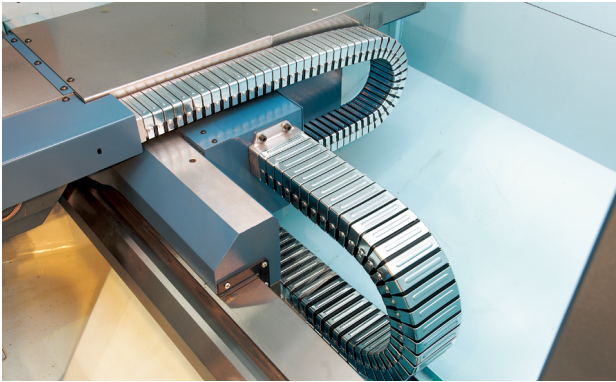

SQ301使用例 (Application example)

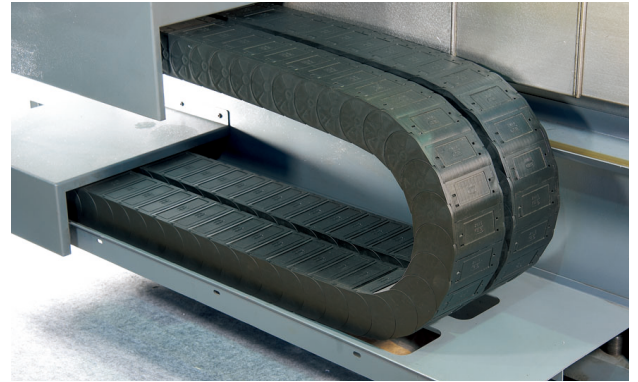

SQ303使用例 (Application example)

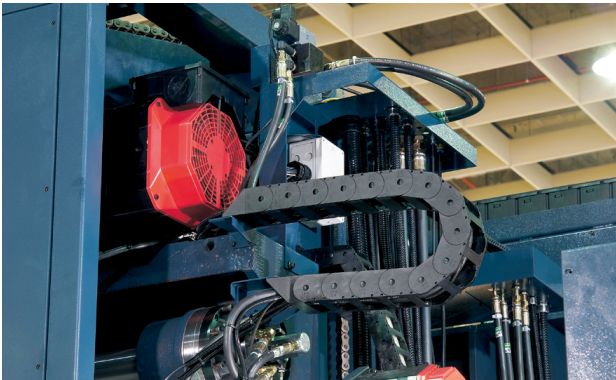

SQ604 使用例 (Application example)



SQ402、SQ502使用例 (Application example)



SQ403使用例 (Application example)

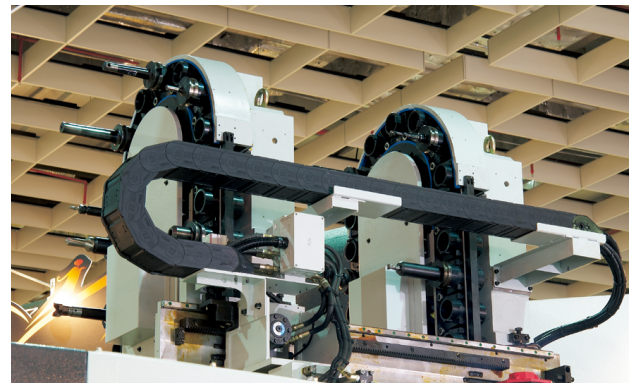

SQ503使用例 (Application example)

購買鏈條護管時稱呼

WHEN BUYING CABLE CHAINS

頁碼	護管型式	番號	內寬	彎曲半徑	長度	法蘭裝置方法
008	SQ303	III (3)		R100	2300L	NO2
012	SQ603	II (2)		R35	800L	NO4
014	SQ604	IV (4)		R40	1500L	NO3
016	SQ812	I(1)	C45	R35	1000L	NO3
017	SQ813	III (3)	C85	R150	1300L	NO5
018	SQ822	II (2)	C105	R100	2000L	NO1
019	SQ823	IV (4)	C150	R250	2200L	NO7
021	SQ602	I (1)		R27	1080L	NO1
022	SQ402	V (5)		R150	3500L	NO7
023	SQ403	III (3)		R225	3000L	NO6
026	SQ502	VI (6)		R200	4500L	NO1
027	SQ503	IV (4)		R350	4000L	NO2
030	SQ301	III (3)		R250	1400L	NO10
032	SQ902	II (2)	C100	R140	5000L	NO2
033	SQ903	III (3)	C300	R500	6500L	NO4



Certificat

Certificate

N° 2019/85259.2

AFNOR Certification certifies that the management system implemented by:
AFNOR Certification certifie que le système de management mis en place par:

SINZ ENTERPRISE CO., LTD.
欣軍企業股份有限公司

for the following activities:
pour les activités suivantes :

DESIGN AND MANUFACTURE OF METAL AND PLASTIC FLEXIBLE CONDUITS AND ATTACHED TERMINALS.
金屬及塑膠軟管及其附屬各式接頭之設計及製造

has been assessed and found to meet the requirements of:
a été évalué et jugé conforme aux exigences requises par :

ISO 9001 : 2015

and is developed on the following locations:
et est déployé sur les sites suivants :

NO.01, IND. NORTH 3RD ROAD, NAN KANG INDUSTRIAL PARK, NAN TOU CITY, TAIWAN R.O.C.
南投市南開工業區工業北三路1號

SING-CHYI ENTERPRISE CO., LTD.
興新企業股份有限公司

NO. 836, SHUANG WEN ROAD, TA-LI DIST, TAICHUNG CITY, TAIWAN, R.O.C.
台中市大里區雙文路 836 號

This certificate is valid from (year/month/day)
Ce certificat est valable à compter du (année/mois/jour)

2023-02-16 until (year/month/day)
jusqu'au **2025-12-24**



Julien NIZRI
Managing Director of AFNOR Certification
Directeur Général de AFNOR Certification



Scan this QR code to check the validity of the certificate

11 rue François de Pressensé - 92571 La Plaine Saint-Denis Cedex - France - T. +33 (0)1 41 62 90 00 - F. +33 (0)1 40 17 90 00
SAS au capital de 19 187 000 € - 419 078 902 RCS Bologny - www.afnor.org

CERTIFICATE OF COMPLIANCE

Certificate Number: 20140906-E241290
Report Reference: E241290-20040405
Issue Date: 2014-SEPTEMBER-06

Issued to: SING CHIUN ENTERPRISE CO LTD
NAN KANG INDUSTRIAL PARK
1 INDUSTRY N 3RD RD
NAN TOU
540 TAIWAN

This is to certify that representative samples of FLEXIBLE METAL CONDUIT, LIQUID-TIGHT Flexible Metal Conduit, Liquid-Tight, Model PT-705, Trade Sizes 3/8, 1/2, 3/4, 1, 1-1/4, 1-1/2, 2, 2-1/2, 3, and 4 in. Have been investigated by UL in accordance with the Standard(s) indicated on this Certificate.

Standard(s) for Safety: UL 360 standard for Liquid Tight flexible Steel Conduit.
Additional Information: See the UL Online Certifications Directory at www.ul.com/database for additional information

Only those products bearing the UL Listing Mark should be considered as being covered by UL's Listing and Follow-Up Service.
The UL Listing Mark generally includes the following elements: the symbol UL in a circle, with the word "LISTED"; a control number (may be alphanumeric) assigned by UL; and the product category name (product identifier) as indicated in the appropriate UL Directory.
Look for the UL Listing Mark on the product.



Page 1 of 1